

EB-G7905U
EB-G7900U
EB-G7500U
EB-G7400U
EB-G7200W
EB-G7000W
EB-G7805
EB-G7800
EB-G7100

Specifications

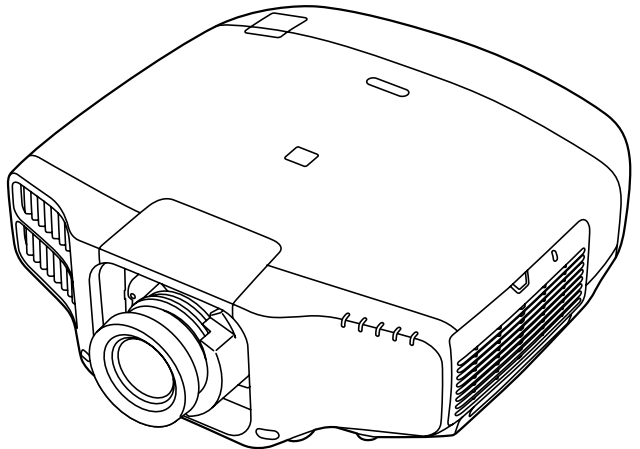

Contents

- Product Overview 3
- Dimensions 10
- Dimensions with Ceiling Mount 12
- Interface 17
- Remote Control Operating Range (Wireless) 18
- Screen Size and Projection Distance 18
- Lens Compatibility Table 35
- Supported Resolutions 36
- Available Lens Shift Adjustment Range 38
- Available Keystone Correction Range 40
- Installation Angle 49
- Installation Environment 50
- Serial Connection 51
- Monitoring and Control 52
- Cautions 66
- Disclaimer 66

■ Product Overview

This product has high luminance and high luminous flux, optimal for projecting in a large space such as a lecture hall or a large conference room. These projectors allow for flexible installation with features such as portrait projection, and come with a variety of adjustment features such as Geometric Correction and Edge Blending.

EB-G7905U/EB-G7900U/EB-G7500U/EB-G7400U

Product Specifications

Product name		EB-G7905U	EB-G7900U	EB-G7500U	EB-G7400U
Projection system		RGB liquid crystal shutter			
Brightness ^{*1*2}		Normal: 7000 lm ECO: 5600 lm Portrait On: 5600 lm		Normal: 6500 lm ECO: 5200 lm Portrait On: 5200 lm	5500 lm Portrait On: 4950 lm
Contrast ratio ^{*2}		50000:1 (Auto Iris: Normal/High Speed)			
Supported RGB signal resolutions		WUXGA ^{*3} , UXGA, WSXGA+, SXGA+, SXGA, WXGA++, WXGA+, WXGA, XGA, SVGA, VGA			
Supported video signals		Component: HDTV (1080i/1080p ^{*4}), HDTV (720p), SDTV (576i/576p), SDTV (480i/480p)			
Supported digital signals		WQXGA ^{*3*5} , WQHD ^{*5} , QXGA ^{*5} , WUXGA ^{*3} , UXGA, WSXGA+, SXGA+, SXGA, WXGA++, WXGA+, WXGA, XGA, SVGA, VGA 4Kx2K (SMPTE) ^{*5} , 4Kx2K ^{*5} , HDTV (1080i/1080p), HDTV (720p), SDTV (576i/576p), SDTV (480i/480p)			
Pixel Number (Width × Height × Number of LCDs)		1920 × 1200 × 3			
LCD panel size (diagonal)		0.76" Wide			
Color reproducibility		Max. 1,070 million colors (Depends on the interface)			
Scanning frequency	Analog	Horizontal: 15 to 92 (KHz) Vertical: 50 to 85 (Hz)			
	HDMI	Horizontal: 15 to 135 (KHz) Vertical: 24, 25, 30, 50, and 60 (Hz)			
	DVI-D	Horizontal: 15 to 75 (KHz) Vertical: 24, 30, 50, and 60 (Hz)			
Projection Lens		Varies depending on the lens			
Zoom ^{*6}	System	Automatic			
	Zoom ratio	Varies depending on the lens			
Focus	System	Automatic			
Lens Shift ^{*7}	Range	Vertical approx. 67%, horizontal approx. 30%			
	System	Automatic			
Dimensions (W × H × D) mm		525 × 164 × 425 (not including raised section)			
Mass ^{*1}		Approx. 12.9 kg			
Lamp Output (W)		400W UHE			
Lamp life	Normal	Normal: Approx. 3000 hours ECO: Approx. 4000 hours			Approx. 4000 hours
	Portrait Mode	Approx. 2000 hours			

Product name		EB-G7905U	EB-G7900U	EB-G7500U	EB-G7400U
Operating temperature ^{*8}		0 to +45°C No condensation (Altitude 0 to 1500 m) 0 to +40°C No condensation (Altitude 1501 to 3048m) 0 to +35°C No condensation (Altitude 3049 to 5000m)			
Power supply		AC 100 - 240 V ± 10%, 50/60 Hz, 6.0 - 2.6 A			AC 100 - 240 V ± 10%, 50/60 Hz, 5.0 - 2.2 A
Power consumption	100 - 120 V Area	Operating: 601 W Standing by (Communication On): 2.2 W Standing by (Communication Off): 0.22 W			Operating: 498 W Standing by (Communication On): 2.2 W Standing by (Communication Off): 0.22 W
	220 - 240 V Area	Operating: 572 W Standing by (Communication On): 2.3 W Standing by (Communication Off): 0.30 W			Operating: 477W Standing by (Communication On): 2.3 W Standing by (Communication Off): 0.30 W
Noise level ^{*2}		Normal: 39 dB ECO: 31 dB			31 dB
Dissipation BTU (max.)	100 - 120 V Area	2043.4 BTU/h			1693.2 BTU/h
	220 - 240 V Area	1944.8 BTU/h			1621.8 BTU/h
Air flow (max.)		71 CFM			
Image input ports		Mini D-Sub 15-pin x1, 5BNC x1, HDMI ^{*9} x1, DVI-D 24 pin x1, HDBaseT ^{*9} x1			
Image output port		Mini D-Sub15-pin x1			
Network		RJ45 (100BASE-TX/10BASE-T) x1 USB connector (A type) x1 (for wireless LAN unit ^{*10} corresponding to IEEE802.11b/g/n)			
Control ports		RJ45 x1, Mini D-Sub9-pin x1 (RS-232C), Stereo mini x1 (for wired remote control), HDBaseT x1, USB connector (Type B) x1			
Speaker		10 W (monaural)			
Function Others		Geometric Correction function, Edge Blending, Portrait Projection ^{*11} , Schedule, A/V Mute, Split Screen, Frame Interpolation, 4K Enhancement, Power Consumption ^{*12} , Password Protection, Memory function, Lens Position Memory, Direct Power On, Direct Shutdown, Network Projection function			

*1 The specifications are when the ELPLM08 is attached.

*2 Measurement, measuring conditions, and methods of notation all comply with the ISO 21118 international standards.

*3 Only VESA CVT-RB (Reduced Blanking) signals are supported.

*4 Only for input signals from the Computer input port.

*5 Only HDMI input is supported.

*6 This is not available for the ELPLR04.

*7 The lens cannot be shifted to the maximum in all four directions. The ELPLR04 does not support lens shift. ELPLX01 has a maximum upward direction of approx. 17% and a maximum horizontal direction of approx. 10%.

*8 When the environmental temperature rises, the lamp's brightness is automatically reduced (EB-G7905U/EB-G7900U/EB-G7500U only. 40°C at an altitude of 0 to 1500 m, 35°C at an altitude of 1501 to 3048 m, and 30°C at an altitude of 3049 to 5000 m).

*9 HDCP 2.2 is supported.

*10 The wireless LAN unit is an optional accessory.

*11 You need a dedicated ceiling mount. Make sure you contact a specialist to request the ceiling mount.

*12 EB-G7905U/EB-G7900U/EB-G7500U only.

EB-G7200W/EB-G7000W

Product Specifications

Product name		EB-G7200W	EB-G7000W
Projection system		RGB liquid crystal shutter	
Brightness ^{*12}		Normal: 7500 lm ECO: 6000 lm Portrait On: 6000 lm	Normal: 6500 lm ECO: 5915 lm Portrait On: 5850 lm
Contrast ratio ^{*2}		50000:1 (Auto Iris: Normal/High Speed)	
Supported RGB signal resolutions		UXGA, WSXGA+, SXGA+, SXGA, WXGA++, WXGA+, WXGA, XGA, SVGA, VGA,	
Supported video signals		Component: HDTV (1080i/1080p ^{*3}), HDTV (720p), SDTV (576i/576p), SDTV (480i/480p)	
Supported digital signals		WUXGA ^{*4} , UXGA, WSXGA+, SXGA+, SXGA, WXGA++, WXGA+, WXGA, XGA, SVGA, VGA, HDTV (1080i/1080p), HDTV (720p), SDTV (576i/576p), SDTV (480i/480p)	
Pixel Number (Width × Height × Number of LCDs)		1280 x 800 x 3	
LCD panel size (diagonal)		0.76" Wide	
Color reproducibility		Approximately 1,070 million colors (Depends on the interface)	
Scanning frequency	Analog	Horizontal: 15 to 92 (KHz) Vertical: 50 to 85 (Hz)	
	HDMI/DVI-D	Horizontal: 15 to 75 (KHz) Vertical: 24, 30, 50, and 60 (Hz)	
Projection lens		Varies depending on the lens	
Zoom ^{*5}	System	Automatic	
	Zoom ratio	Varies depending on the lens	
Focus	System	Automatic	
Lens Shift ^{*6}	Range	Vertical approx. 67%, horizontal approx. 30%	
	System	Automatic	
Dimensions (W × H × D) mm		525 × 164 × 425 (not including raised section)	
Mass ^{*1}		Approx. 12.9 kg	
Lamp Output (W)		400W UHE	
Lamp life	Normal	Normal: Approx. 3000 hours ECO: Approx. 4000 hours	
	Portrait Mode	Approx. 2000 hours	
Operating temperature ^{*7}		0 to +45°C No condensation (Altitude 0 to 1500m) 0 to +40°C No condensation (Altitude 1501 to 3048m) 0 to +35°C No condensation (Altitude 3049 to 5000m)	

Product name		EB-G7200W	EB-G7000W
Power supply		AC 100 - 240 V \pm 10%, 50/60 Hz, 6.0 - 2.6 A	AC 100 - 240 V \pm 10%, 50/60 Hz, 5.5 - 2.4A
Power consumption	100 - 120 V Area	Operating: 601 W Standing by (Communication On): 2.2 W Standing by (Communication Off): 0.22 W	Operating: 540W Standing by (Communication On): 2.2 W Standing by (Communication Off): 0.22 W
	220 - 240 V Area	Operating: 572 W Standing by (Communication On): 2.3 W Standing by (Communication Off): 0.30 W	Operating: 515W Standing by (Communication On): 2.3 W Standing by (Communication Off): 0.30 W
Noise level ²		Normal: 39 dB ECO: 31 dB	Normal: 35 dB ECO: 31 dB
Dissipation BTU (max.)	100 - 120 V Area	2043.4 BTU/h	1836.0 BTU/h
	220 - 240 V Area	1944.8 BTU/h	1751.0 BTU/h
Air flow (max.)		71 CFM	
Image input ports		Mini D-Sub 15-pin x1, 5BNC x1, HDMI x1, DVI-D 24 pin x1, HDBaseT x1	
Image output port		Mini D-Sub15-pin x1	
Network		RJ45 (100BASE-TX/10BASE-T) x1 USB connector (A type) x1 (for wireless LAN unit ⁸ corresponding to IEEE802.11b/g/n)	
Control ports		RJ45 x1, Mini D-Sub9-pin x1 (RS-232C), Stereo mini x1 (for wired remote control), HDBaseT x1, USB connector (Type B) x1	
Speaker		10 W (monaural)	
Function Others		Geometric Correction function, Edge Blending, Portrait Projection ⁹ , Schedule, A/V Mute, Split Screen, Frame Interpolation, Power Consumption, Password Protection, Memory function, Lens Position Memory, Direct Power On, Direct Shutdown, Network Projection function	

*1 The specifications are when the ELPLM08 is attached.

*2 Measurement, measuring conditions, and methods of notation all comply with the ISO 21118 international standards.

*3 Only for input signals from the Computer input port.

*4 Only VESA CVT-RB (Reduced Blanking) signals are supported.

*5 This is not available for the ELPLR04.

*6 The lens cannot be shifted to the maximum in all four directions. The ELPLR04 does not support lens shift. ELPLX01 has a maximum upward direction of approx. 17% and a maximum horizontal direction of approx. 10%.

*7 When the environmental temperature rises, the lamp's brightness is automatically reduced (40°C at an altitude of 0 to 1500 m, 35°C at an altitude of 1501 to 3048 m, and 30°C at an altitude of 3049 to 5000 m).

*8 The wireless LAN unit is an optional accessory.

*9 You need a dedicated ceiling mount. Make sure you contact a specialist to request the ceiling mount.

EB-G7805/EB-G7800/EB-G7100

Product Specifications

Product name		EB-G7805	EB-G7800	EB-G7100
Projection system		RGB liquid crystal shutter		
Brightness ^{*1*2}		Normal: 8000 lm ECO: 6400 lm Portrait On: 6400 lm		Normal: 6500 lm ECO: 5915 lm Portrait On: 5850 lm
Contrast ratio ^{*2}		50000:1 (Auto Iris: Normal/High Speed)		
Supported RGB signal resolutions		UXGA, SXGA+, SXGA, WXGA++, WXGA+, WXGA, XGA, SVGA, VGA		
Supported video signals		Component: HDTV (1080i/1080p ^{*3}), HDTV (720p), SDTV (576i/576p), SDTV (480i/480p)		
Supported digital signals		WUXGA ^{*4} , UXGA, SXGA+, SXGA, WXGA++, WXGA+, WXGA, XGA, SVGA, VGA HDTV (1080i/1080p), HDTV (720p), SDTV (576i/576p), SDTV (480i/480p)		
Pixel Number (Width × Height × Number of LCDs)		1024 x 768 x 3		
LCD panel size (diagonal)		0.79"		
Color reproducibility		Approximately 1,070 million colors (Depends on the interface)		
Scanning frequency	Analog	Horizontal: 15 to 92 (KHz) Vertical: 50 to 85 (Hz)		
	HDMI/DVI-D	Horizontal: 15 to 75 (KHz) Vertical: 24, 30, 50, and 60 (Hz)		
Projection lens		Varies depending on the lens		
Zoom ^{*5}	System	Automatic		
	Zoom ratio	Varies depending on the lens		
Focus	System	Automatic		
Lens Shift ^{*6}	Range	Vertical approx. 57%, horizontal approx. 30%		
	System	Automatic		
Dimensions (W × H × D) mm		525 × 164 × 425 (not including raised section)		
Mass ^{*1}		Approx. 12.9 kg		
Lamp Output (W)		400W UHE		
Lamp replacement cycle	Normal	Normal: Approx. 3000 hours ECO: Approx. 4000 hours		
	Portrait Mode	Approx. 2000 hours		
Operating temperature ^{*7}		0 to +45°C No condensation (Altitude 0 to 1500m) 0 to +40°C No condensation (Altitude 1501 to 3048m) 0 to +35°C No condensation (Altitude 3049 to 5000m)		
Power supply		AC 100 - 240 V ± 10%, 50/60 Hz, 6.0 - 2.6 A		AC 100 - 240 V ± 10%, 50/60 Hz, 5.5 - 2.4A

Product name		EB-G7805	EB-G7800	EB-G7100
Power consumption	100 - 120 V Area	Operating: 601 W Standing by (Communication On): 2.2 W Standing by (Communication Off): 0.22 W		Operating: 540 W Standing by (Communication On): 2.2W Standing by (Communication Off): 0.22W
	220 - 240 V Area	Operating: 572 W Standing by (Communication On): 2.3 W Standing by (Communication Off): 0.30 W		Operating: 515W Standing by (Communication On): 2.3 W Standing by (Communication Off): 0.30 W
Noise level ²		Normal: 39 dB ECO: 31 dB		Normal: 35 dB ECO: 31 dB
Dissipation BTU (max.)	100 - 120 V Area	2043.4 BTU/h		1836.0 BTU/h
	220 - 240 V Area	1944.8 BTU/h		1751.0 BTU/h
Air flow (max.)		71 CFM		
Image input ports		Mini D-Sub 15-pin x1, 5BNC x1, HDMI x1, DVI-D 24 pin x1, HDBaseT x1		
Image output port		Mini D-Sub15-pin x1		
Network		RJ45 (100BASE-TX/10BASE-T) x1 USB connector (A type) x1 (for wireless LAN unit ^{*8} corresponding to IEEE802.11b/g/n)		
Control ports		RJ45 x1, Mini D-Sub9-pin x1 (RS-232C), Stereo mini x1 (for wired remote control), HDBaseT x1, USB connector (Type B) x1		
Speaker		10 W (monaural)		
Function Others		Geometric Correction function, Edge Blending, Portrait Projection ^{*9} , Schedule, A/V Mute, Split Screen, Frame Interpolation, Power Consumption, Password Protection, Memory function, Lens Position Memory, Direct Power On, Direct Shutdown, Network Projection function		

*1 The specifications are when the ELPLM08 is attached.

*2 Measurement, measuring conditions, and methods of notation all comply with the ISO 21118 international standards.

*3 Only for input signals from the Computer input port.

*4 Only VESA CVT-RB (Reduced Blanking) signals are supported.

*5 This is not available for the ELPLR04.

*6 The lens cannot be shifted to the maximum in all four directions. The ELPLR04 does not support lens shift. ELPLX01 has a maximum upward direction of approx. 7% and a maximum horizontal direction of approx. 8%.

*7 When the environmental temperature rises, the lamp's brightness is automatically reduced (40°C at an altitude of 0 to 1500 m, 35°C at an altitude of 1501 to 3048 m, and 30°C at an altitude of 3049 to 5000 m).

*8 The wireless LAN unit is an optional accessory.

*9 You need a dedicated ceiling mount. Make sure you contact a specialist to request the ceiling mount.

Lens Specifications

Values are just reference.

Lens Model Number	Projector Size when Lens Installed D (mm)	Lens Mass	F value	f (mm)	Zoom Rate	Optical Power Comparison
ELPLM08	472	1200g	1.7 - 2.3	24.0 - 38.2	1.6	100% (standard)
ELPLX01	488	3500g	1.9	5.8	-	83 to 88%
ELPLU03	512	1800g	2.0 - 2.3	11.1 - 13.1	1.2	82 to 90%
ELPLU04	539	3100g	2.0 - 2.1	14.8 - 17.7	1.2	87 to 94%
ELPLW05	480	1450g	2.0 - 2.2	17.6 - 24.3	1.4	84 to 91%
ELPLW06	513	2950g	1.8 - 2.3	27.3 - 37.0	1.4	93 to 96%
ELPLM09	477	1900g	1.8 - 2.5	36.0 - 57.4	1.6	98 to 100%
ELPLM10	519	2200g	1.8 - 2.4	55.4 - 83.3	1.5	95 to 100%
ELPLM11	523	2200g	1.8 - 2.4	80.6 - 121.1	1.5	91 to 96%
ELPLL08	523	2200g	1.8 - 2.5	119.0 - 165.4	1.4	91 to 96%

When using the following lenses, set the model number for the lens being used in [Extended] - [Operation] - [Lens Type] from the projector's Configuration menu.

Lens Model Number	Projector Size when Lens Installed D (mm)	Lens Mass	F value	f (mm)	Zoom Rate	Optical Power Comparison
ELPLS04	477	1820g	1.7 - 2.5	36.0 - 57.4	1.6	101 to 105%
ELPLU02	539	3000 g	2.0 - 2.1	14.8 - 17.7	1.2	87 to 94%
ELPLR04	478	1950g	1.9	16.2	-	88 to 95%
ELPLW04	513	2860g	1.8 - 2.3	27.3 - 37.0	1.4	93 to 96%
ELPLM06	519	2600g	1.8 - 2.4	55.4 - 83.3	1.5	95 to 100%
ELPLM07	523	2200g	1.8 - 2.3	80.6 - 121.1	1.5	91 to 96%
ELPLL07	523	2200g	1.8 - 2.5	119.0 - 165.4	1.4	91 to 96%

Ceiling Mount Mass

You need a dedicated ceiling mount to suspend the projector from a ceiling. Special expertise is required to suspend the projector from a ceiling. For safety reasons, do not install the projector yourself. Installation entails a separate cost.

Mass		
Ceiling Mount	ELPMB22	3.5kg
Pipe 450 (450 mm)	ELPFP13	2.1kg
Pipe 700 (700 mm)	ELPFP14	2.6kg

Mass		
Low ceiling mount	ELPMB47	11kg
High ceiling mount	ELPMB48	16kg

■ Dimensions

[Units: mm]

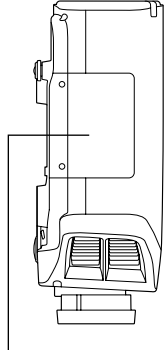
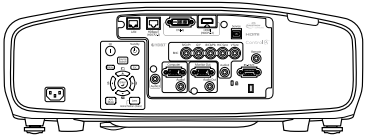

Lamp cover
You need screwdriver #2 to replace the lamp.

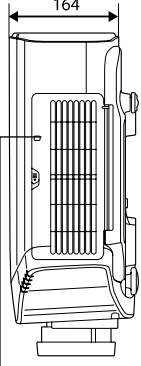
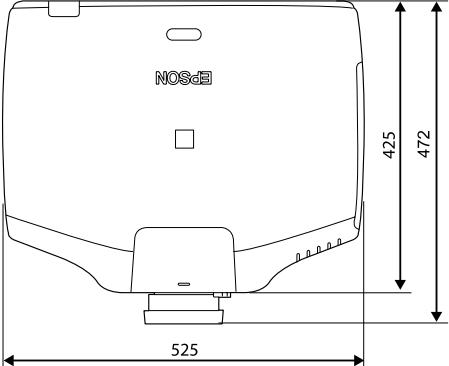

Wireless LAN unit installation section
(Inside the air filter cover)

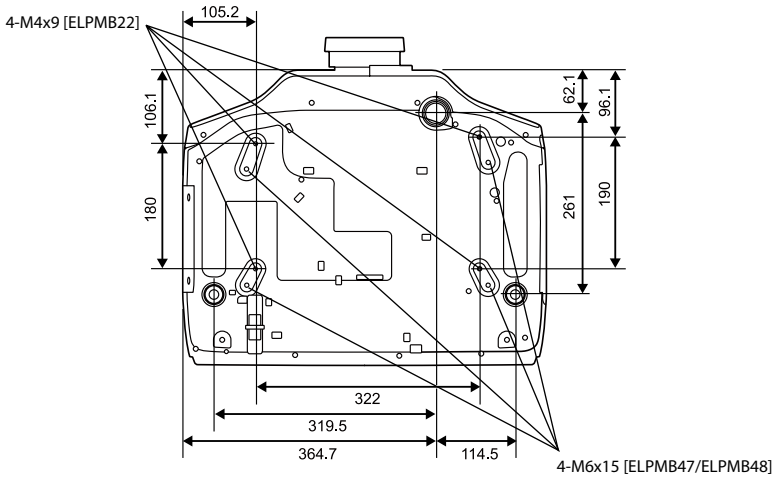
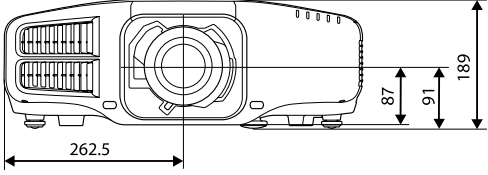

The figures and numbers are when the ELPLM08 is attached.

When lens unit ELPLX01 is installed

[Units: mm]

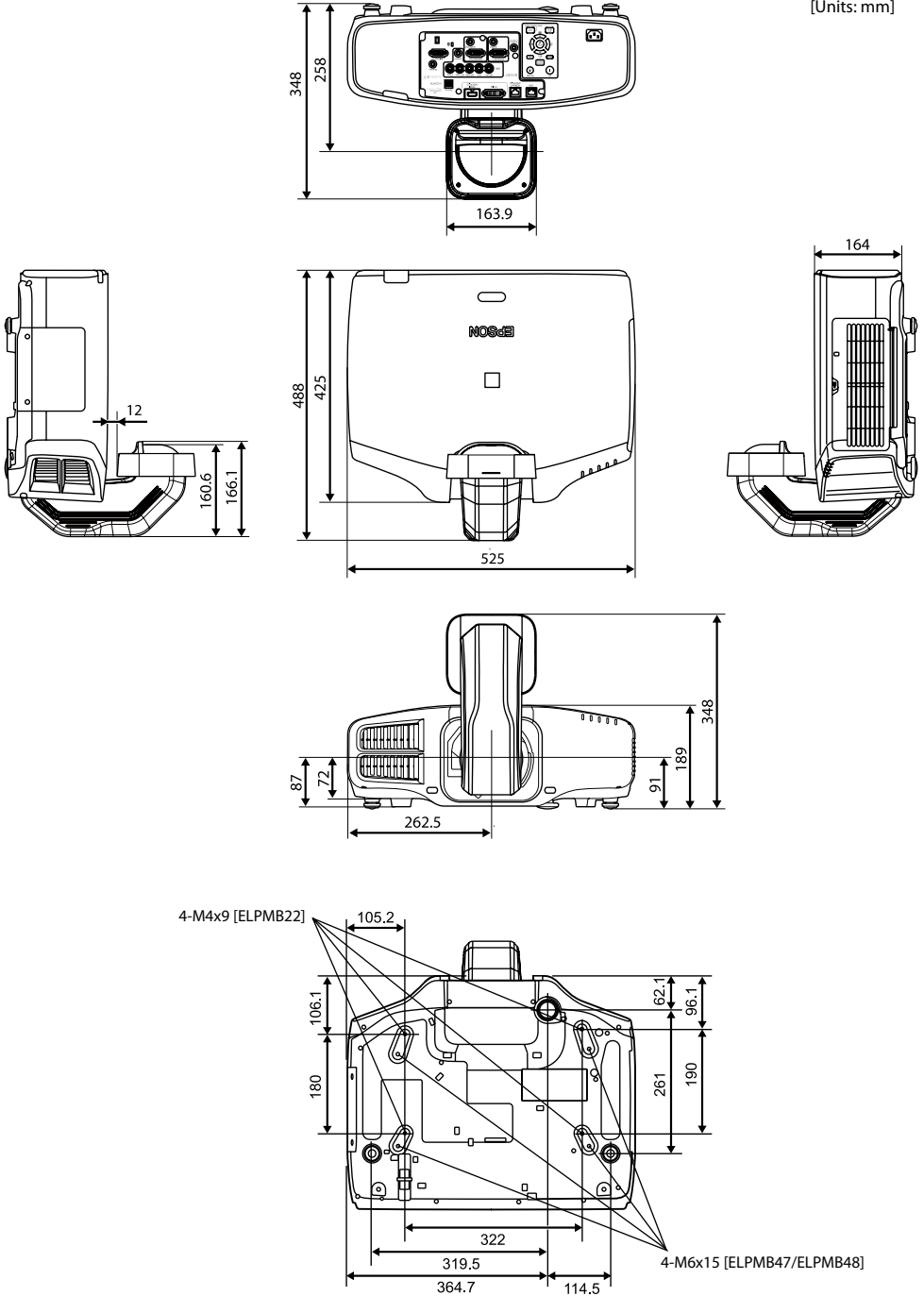

■ Dimensions with Ceiling Mount

For ELPMB22

[Units: mm]

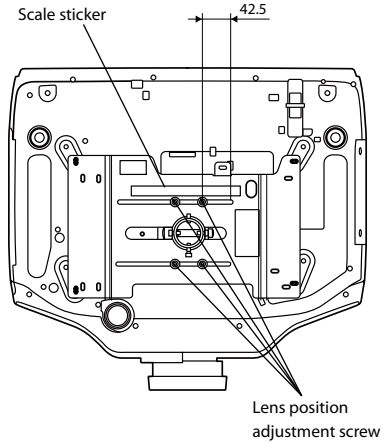
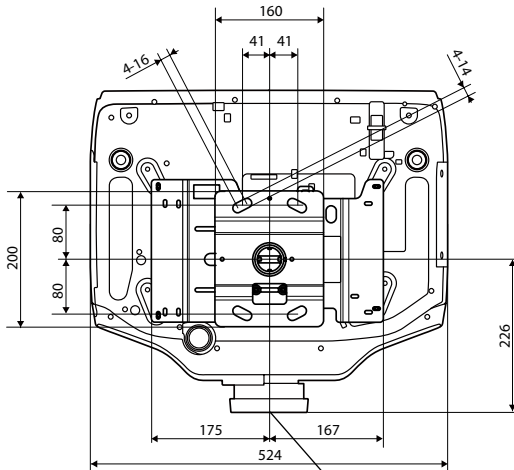

Align the central point of ceiling mount ELPMB22 with the center of the projector's lens. (See the figure on the right)

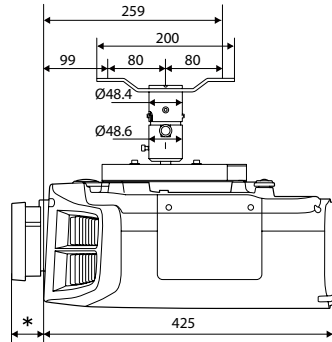
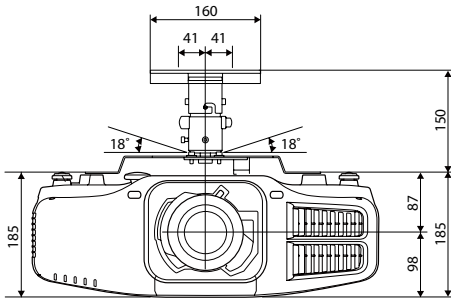

* Amount of lens protrusion

Lens Model Number	Amount of lens protrusion
ELPLM08	47 mm
ELPLX01	63 mm
ELPLU03	87 mm
ELPLU04	114 mm
ELPLW05	55 mm
ELPLW06	88 mm
ELPLM09	52 mm
ELPLM10	94 mm
ELPLM11	98 mm

Lens Model Number	Amount of lens protrusion
ELPLL08	98 mm
ELPLS04	52 mm
ELPLU02	114 mm
ELPLR04	53 mm
ELPLW04	88 mm
ELPLM06	94 mm
ELPLM07	98 mm
ELPLL07	98 mm

The figures and numbers are when the ELPLM08 is attached.

For ELPMB22 and ELPFP13 (Pipe 450)

[Units: mm]

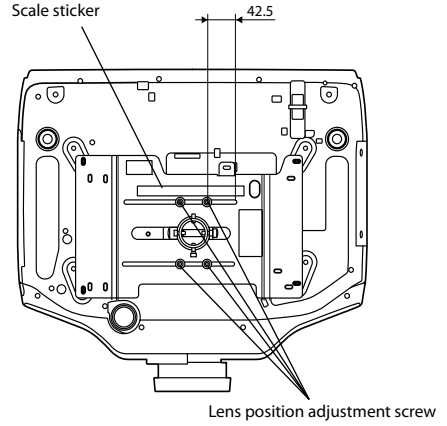
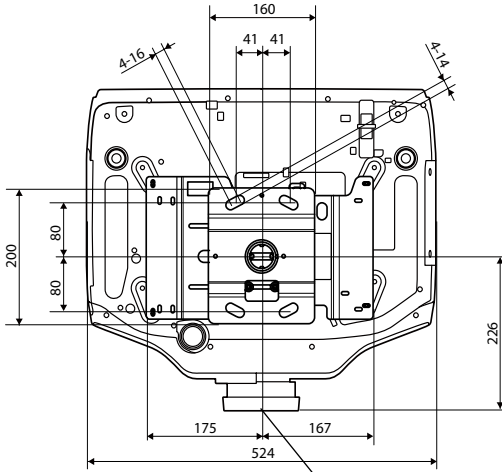

Align the central point of ceiling mount ELPMB22 with the center of the projector's lens. (See the figure on the right)

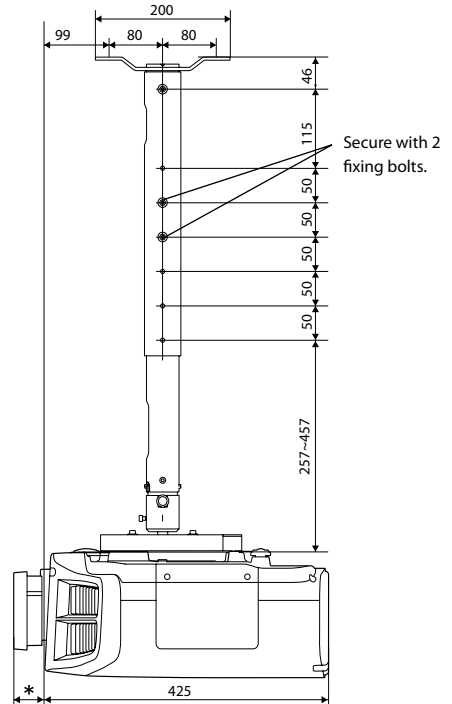
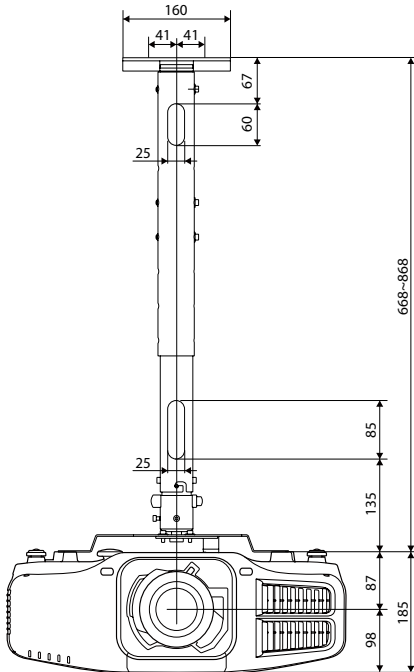

The figures and numbers are when the ELPLM08 is attached.

* For details on the amount of lens protrusion, see p.12.

For ELPMB22 and ELPFP14 (Pipe 700)

[Units: mm]

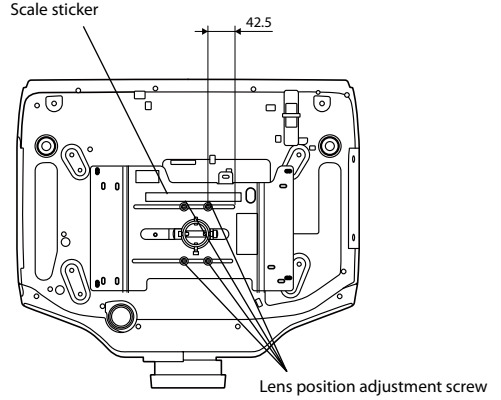
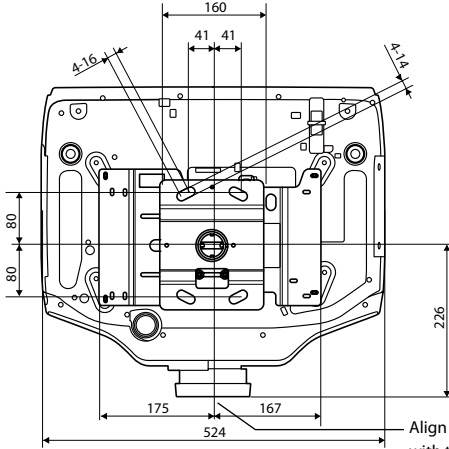

Align the central point of ceiling mount ELPMB22 with the center of the projector's lens. (See the figure on the right)

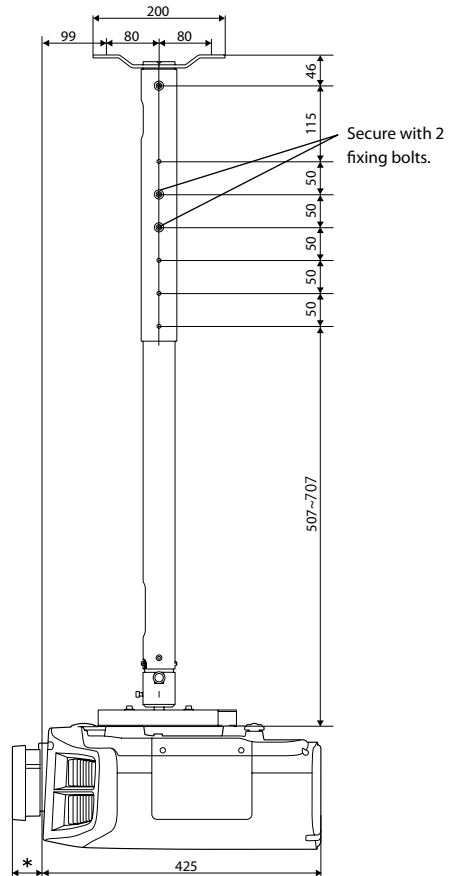
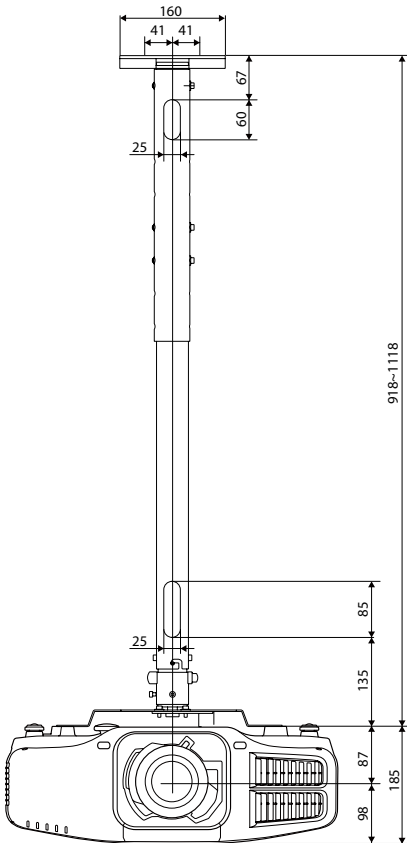

The figures and numbers are when the ELPLM08 is attached.

* For details on the amount of lens protrusion, see p.12.

For ELPMB47 (Low ceiling mount)

[Units: mm]

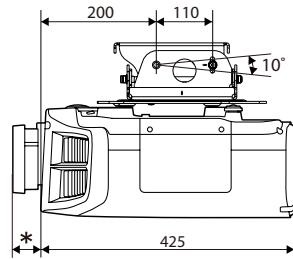
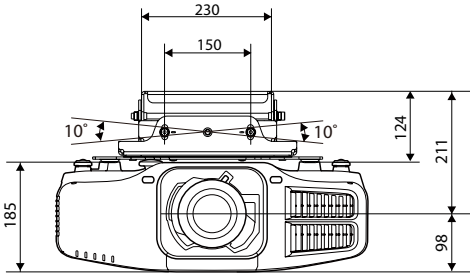
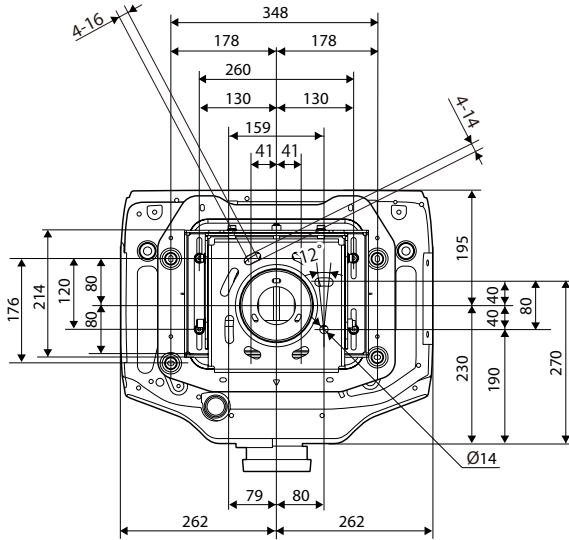

The figures and numbers are when the ELPLM08 is attached.

* For details on the amount of lens protrusion, see p.12.

Interface

*Position of interface on projector

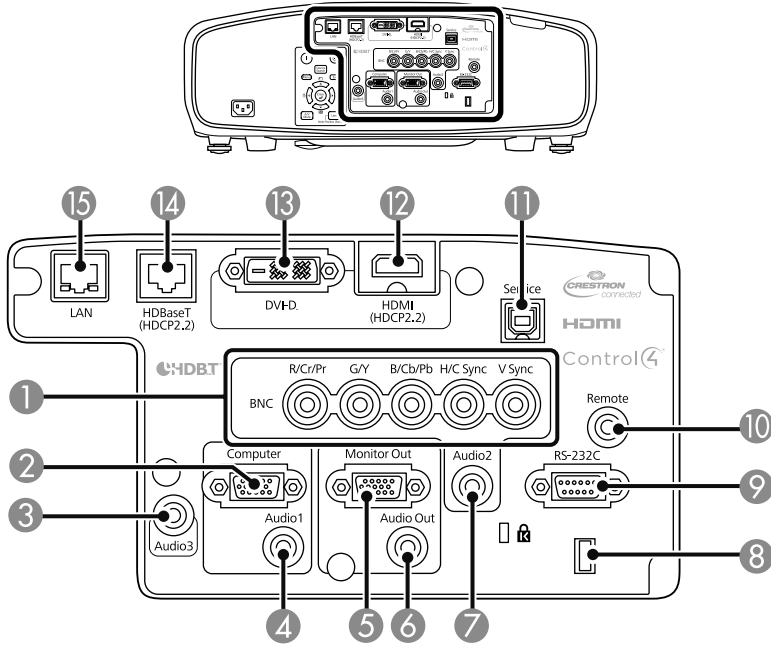

No	Name	No	Name
1	BNC input port (5BNC)	9	RS-232C port (Mini D-Sub 9-pin)
2	Computer input port (Mini D-Sub15-pin)	10	Remote port (stereo mini)
3	Audio3 input port (stereo mini)	11	Service port (USB Type-B) ^{*3}
4	Audio1 input port (stereo mini)	12	HDMI input port (HDMI HDCP) ^{*4}
5	Monitor Out port (Mini D-Sub15-pin) ^{*1}	13	DVI-D input port (DVI-D 24-pin)
6	Audio Out port (stereo mini) ^{*2}	14	HDBaseT port (HDBaseT RJ45) ^{*4 *5}
7	Audio2 input port (stereo mini)	15	LAN port (RJ45: 100Base-TX)
8	Cable holder		

*1 Only analog RGB signals can be output from the BNC port and the Computer port.

*2 Outputs audio from the HDMI/HDBaseT/DVI-D/Computer/BNC/LAN input source.

*3 For maintenance personnel only. Should not normally be used.

*4 HDCP 2.2 is supported. (EB-G7905U/EB-G7900U/EB-G7500U/EB-G7400U only).

*5 Make sure you use LAN cables that are straight STP cables, category 5e or higher, and recommended by the HDBaseT Alliance.

Remote Control Operating Range (Wireless)

The following shows the operation range for the remote control supplied with the projector.

Left/Right

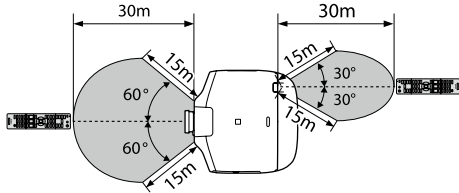

Up/Down

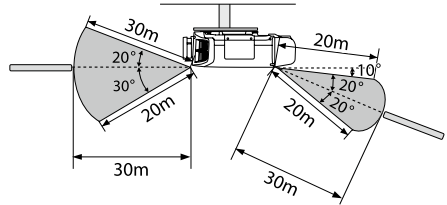

Screen Size and Projection Distance

See page 10 to 16 for the distances from the ceiling plate to each part of the projector.

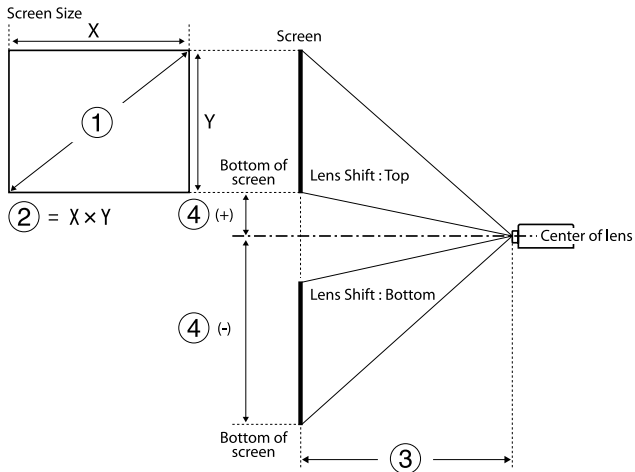

① Screen size (inches)

② Screen size (width x height)

③ Projection distance (Minimum: Wide to Maximum: Tele)

④ Distance from the center of the lens to the bottom of the screen

Projection Distance Formula by Lens

EB-G7905U/EB-G7900U/EB-G7500U/EB-G7400U/EB-G7200W/EB-G7000W

<For screens with an aspect ratio of 16:10>

Projection Lens	Projection Distance (③) Formula	
ELPLM08	Minimum	Projection distance (cm)= Projection screen size (inches) x 3.16-5.00
	Maximum	Projection distance (cm)= Projection screen size (inches) x 5.05-4.49
ELPLX01	-	Projection distance (cm)= Projection screen size (inches) x 0.79-5.16
ELPLU03	Minimum	Projection distance (cm)= Projection screen size (inches) x 1.44-3.77
	Maximum	Projection distance (cm)= Projection screen size (inches) x 1.72-3.63
ELPLU04/ELPLU02	Minimum	Projection distance (cm)= Projection screen size (inches) x 1.94-5.72
	Maximum	Projection distance (cm)= Projection screen size (inches) x 2.33-5.68
ELPLW05	Minimum	Projection distance (cm)= Projection screen size (inches) x 2.32-7.65
	Maximum	Projection distance (cm)= Projection screen size (inches) x 3.21-5.81
ELPLW06/ELPLW04	Minimum	Projection distance (cm)= Projection screen size (inches) x 3.58-7.32
	Maximum	Projection distance (cm)= Projection screen size (inches) x 4.87-8.32
ELPLM09/ELPLS04	Minimum	Projection distance (cm)= Projection screen size (inches) x 4.73-8.00
	Maximum	Projection distance (cm)= Projection screen size (inches) x 7.59-7.93
ELPLM10/ELPLM06	Minimum	Projection distance (cm)= Projection screen size (inches) x 7.30-13.04
	Maximum	Projection distance (cm)= Projection screen size (inches) x 11.03-13.01
ELPLM11/ELPLM07	Minimum	Projection distance (cm)= Projection screen size (inches) x 10.70-23.67
	Maximum	Projection distance (cm)= Projection screen size (inches) x 16.14-23.47
ELPLL08/ELPLL07	Minimum	Projection distance (cm)= Projection screen size (inches) x 15.87-31.85
	Maximum	Projection distance (cm)= Projection screen size (inches) x 22.11-31.62
ELPLR04	-	Projection distance (cm)= Projection screen size (inches) x 2.12-6.10

Distance from the center of the lens to the base of the screen (except for ELPLR04): ④ (+) (cm) = screen size (inches) x 0.24

④ (-) (cm) = screen size (inches) x 1.58

Distance from the center of the lens to the base of the screen (for ELPLR04):

④ (+)/(-) (cm) = screen size (inches) x 0.67

<For screens with an aspect ratio of 16:9>

Projection Lens	Projection Distance (③) Formula	
ELPLM08	Minimum	Projection distance (cm)= Projection screen size (inches) x 3.25-5.00
	Maximum	Projection distance (cm)= Projection screen size (inches) x 5.19-4.49
ELPLX01	-	Projection distance (cm)= Projection screen size (inches) x 0.81-5.16
ELPLU03	Minimum	Projection distance (cm)= Projection screen size (inches) x 1.48-3.77
	Maximum	Projection distance (cm)= Projection screen size (inches) x 1.77-3.63
ELPLU04/ELPLU02	Minimum	Projection distance (cm)= Projection screen size (inches) x 1.99-5.72
	Maximum	Projection distance (cm)= Projection screen size (inches) x 2.39-5.68
ELPLW05	Minimum	Projection distance (cm)= Projection screen size (inches) x 2.39-7.65
	Maximum	Projection distance (cm)= Projection screen size (inches) x 3.30-5.81

Projection Lens	Projection Distance (㉓) Formula	
ELPLW06/ELPLW04	Minimum	Projection distance (cm)= Projection screen size (inches) x 3.68-7.32
	Maximum	Projection distance (cm)= Projection screen size (inches) x 5.00-8.32
ELPLM09/ELPLS04	Minimum	Projection distance (cm)= Projection screen size (inches) x 4.86-8.00
	Maximum	Projection distance (cm)= Projection screen size (inches) x 7.80-7.93
ELPLM10/ELPLM06	Minimum	Projection distance (cm)= Projection screen size (inches) x 7.50-13.04
	Maximum	Projection distance (cm)= Projection screen size (inches) x 11.34-13.01
ELPLM11/ELPLM07	Minimum	Projection distance (cm)= Projection screen size (inches) x 11.00-23.67
	Maximum	Projection distance (cm)= Projection screen size (inches) x 16.59-23.47
ELPLL08/ELPLL07	Minimum	Projection distance (cm)= Projection screen size (inches) x 16.31-31.85
	Maximum	Projection distance (cm)= Projection screen size (inches) x 22.73-31.62
ELPLR04	-	Projection distance (cm)= Projection screen size (inches) x 2.18-6.10

Distance from the center of the lens to the base of the screen (except for ELPLR04): ㉔ (+) (cm) = screen size (inches) x 0.31

㉔ (-) (cm) = screen size (inches) x 1.56

Distance from the center of the lens to the base of the screen (for ELPLR04):

㉔ (+)/(-) (cm) = screen size (inches) x 0.62

<For screens with an aspect ratio of 4:3>

Projection Lens	Projection Distance (㉓) Formula	
ELPLM08	Minimum	Projection distance (cm)= Projection screen size (inches) x 3.58-5.00
	Maximum	Projection distance (cm)= Projection screen size (inches) x 5.72-4.49
ELPLX01	-	Projection distance (cm)= Projection screen size (inches) x 0.89-5.16
ELPLU03	Minimum	Projection distance (cm)= Projection screen size (inches) x 1.63-3.77
	Maximum	Projection distance (cm)= Projection screen size (inches) x 1.95-3.63
ELPLU04/ELPLU02	Minimum	Projection distance (cm)= Projection screen size (inches) x 2.20-5.72
	Maximum	Projection distance (cm)= Projection screen size (inches) x 2.64-5.68
ELPLW05	Minimum	Projection distance (cm)= Projection screen size (inches) x 2.63-7.65
	Maximum	Projection distance (cm)= Projection screen size (inches) x 3.63-5.81
ELPLW06/ELPLW04	Minimum	Projection distance (cm)= Projection screen size (inches) x 4.05-7.32
	Maximum	Projection distance (cm)= Projection screen size (inches) x 5.51-8.32
ELPLM09/ELPLS04	Minimum	Projection distance (cm)= Projection screen size (inches) x 5.35-8.00
	Maximum	Projection distance (cm)= Projection screen size (inches) x 8.59-7.93
ELPLM10/ELPLM06	Minimum	Projection distance (cm)= Projection screen size (inches) x 8.26-13.04
	Maximum	Projection distance (cm)= Projection screen size (inches) x 12.49-13.01
ELPLM11/ELPLM07	Minimum	Projection distance (cm)= Projection screen size (inches) x 12.11-23.67
	Maximum	Projection distance (cm)= Projection screen size (inches) x 18.27-23.47
ELPLL08/ELPLL07	Minimum	Projection distance (cm)= Projection screen size (inches) x 17.96-31.85
	Maximum	Projection distance (cm)= Projection screen size (inches) x 25.03-31.62
ELPLR04	-	Projection distance (cm)= Projection screen size (inches) x 2.40-6.10

Distance from the center of the lens to the base of the screen (except for ELPLR04): ㉔ (+) (cm) = screen size (inches) x 0.27

㉔ (-) (cm) = screen size (inches) x 1.79

Distance from the center of the lens to the base of the screen (for ELPLR04):

㉔ (+)/(-) (cm) = screen size (inches) x 0.76

EB-G7805/EB-G7800/EB-G7100

<For screens with an aspect ratio of 4:3>

Projection Lens	Projection Distance (㉓) Formula	
ELPLM08	Minimum	Projection distance (cm)= Projection screen size (inches) x 3.05-5.05
	Maximum	Projection distance (cm)= Projection screen size (inches) x 4.87-4.52
ELPLX01	-	Projection distance (cm)= Projection screen size (inches) x 0.76-5.38
ELPLU03	Minimum	Projection distance (cm)= Projection screen size (inches) x 1.38-3.63
	Maximum	Projection distance (cm)= Projection screen size (inches) x 1.66-3.41
ELPLU04/ELPLU02	Minimum	Projection distance (cm)= Projection screen size (inches) x 1.87-5.64
	Maximum	Projection distance (cm)= Projection screen size (inches) x 2.25-5.58
ELPLW05	Minimum	Projection distance (cm)= Projection screen size (inches) x 2.24-7.78
	Maximum	Projection distance (cm)= Projection screen size (inches) x 3.09-5.79
ELPLW06/ELPLW04	Minimum	Projection distance (cm)= Projection screen size (inches) x 3.45-7.40
	Maximum	Projection distance (cm)= Projection screen size (inches) x 4.69-7.18
ELPLM09/ELPLS04	Minimum	Projection distance (cm)= Projection screen size (inches) x 4.55-8.03
	Maximum	Projection distance (cm)= Projection screen size (inches) x 7.32-7.95
ELPLM10/ELPLM06	Minimum	Projection distance (cm)= Projection screen size (inches) x 7.03-13.08
	Maximum	Projection distance (cm)= Projection screen size (inches) x 10.64-13.03
ELPLM11/ELPLM07	Minimum	Projection distance (cm)= Projection screen size (inches) x 10.31-23.72
	Maximum	Projection distance (cm)= Projection screen size (inches) x 15.56-23.49
ELPLL08/ELPLL07	Minimum	Projection distance (cm)= Projection screen size (inches) x 15.29-31.95
	Maximum	Projection distance (cm)= Projection screen size (inches) x 21.32-31.66
ELPLR04	-	Projection distance (cm)= Projection screen size (inches) x 2.04-6.15

Distance from the center of the lens to the base of the screen (except for ELPLR04): ㉔ (+) (cm) = screen size (inches) x 0.12

㉔ (-) (cm) = screen size (inches) x 1.64

Distance from the center of the lens to the base of the screen (for ELPLR04):

㉔ (+)/(-) (cm) = screen size (inches) x 0.76

<For screens with an aspect ratio of 16:9>

Projection Lens	Projection Distance (㉓) Formula	
ELPLM08	Minimum	Projection distance (cm)= Projection screen size (inches) x 3.32-5.05
	Maximum	Projection distance (cm)= Projection screen size (inches) x 5.31-4.52
ELPLX01	-	Projection distance (cm)= Projection screen size (inches) x 0.83-5.38
ELPLU03	Minimum	Projection distance (cm)= Projection screen size (inches) x 1.50-3.63
	Maximum	Projection distance (cm)= Projection screen size (inches) x 1.81-3.41
ELPLU04/ELPLU02	Minimum	Projection distance (cm)= Projection screen size (inches) x 2.04-5.64
	Maximum	Projection distance (cm)= Projection screen size (inches) x 2.45-5.58
ELPLW05	Minimum	Projection distance (cm)= Projection screen size (inches) x 2.44-7.78
	Maximum	Projection distance (cm)= Projection screen size (inches) x 3.37-5.79
ELPLW06/ELPLW04	Minimum	Projection distance (cm)= Projection screen size (inches) x 3.75-7.40
	Maximum	Projection distance (cm)= Projection screen size (inches) x 5.10-7.18

Projection Lens	Projection Distance (㉓) Formula	
ELPLM09/ELPLS04	Minimum	Projection distance (cm)= Projection screen size (inches) x 4.96-8.03
	Maximum	Projection distance (cm)= Projection screen size (inches) x 7.97-7.95
ELPLM10/ELPLM06	Minimum	Projection distance (cm)= Projection screen size (inches) x 7.66-13.08
	Maximum	Projection distance (cm)= Projection screen size (inches) x 11.59-13.03
ELPLM11/ELPLM07	Minimum	Projection distance (cm)= Projection screen size (inches) x 11.23-23.72
	Maximum	Projection distance (cm)= Projection screen size (inches) x 16.95-23.49
ELPLL08/ELPLL07	Minimum	Projection distance (cm)= Projection screen size (inches) x 16.65-31.95
	Maximum	Projection distance (cm)= Projection screen size (inches) x 23.23-31.66
ELPLR04	-	Projection distance (cm)= Projection screen size (inches) x 2.22-6.15

Distance from the center of the lens to the base of the screen (except for ELPLR04): ㉔ (+) (cm) = screen size (inches) x 0.33

㉔ (-) (cm) = screen size (inches) x 1.58

Distance from the center of the lens to the base of the screen (for ELPLR04): ㉔ (+)/(-) (cm) = screen size (inches) x 0.62

<For screens with an aspect ratio of 16:10>

Projection Lens	Projection Distance (㉓) Formula	
ELPLM08	Minimum	Projection distance (cm)= Projection screen size (inches) x 3.23-5.05
	Maximum	Projection distance (cm)= Projection screen size (inches) x 5.16-4.52
ELPLX01	-	Projection distance (cm)= Projection screen size (inches) x 0.81-5.38
ELPLU03	Minimum	Projection distance (cm)= Projection screen size (inches) x 1.46-3.63
	Maximum	Projection distance (cm)= Projection screen size (inches) x 1.76-3.41
ELPLU04/ELPLU02	Minimum	Projection distance (cm)= Projection screen size (inches) x 1.98-5.64
	Maximum	Projection distance (cm)= Projection screen size (inches) x 2.39-5.58
ELPLW05	Minimum	Projection distance (cm)= Projection screen size (inches) x 2.37-7.78
	Maximum	Projection distance (cm)= Projection screen size (inches) x 3.28-5.79
ELPLW06/ELPLW04	Minimum	Projection distance (cm)= Projection screen size (inches) x 3.65-7.40
	Maximum	Projection distance (cm)= Projection screen size (inches) x 4.97-7.18
ELPLM09/ELPLS04	Minimum	Projection distance (cm)= Projection screen size (inches) x 4.82-8.03
	Maximum	Projection distance (cm)= Projection screen size (inches) x 7.76-7.95
ELPLM10/ELPLM06	Minimum	Projection distance (cm)= Projection screen size (inches) x 7.45-13.08
	Maximum	Projection distance (cm)= Projection screen size (inches) x 11.28-13.03
ELPLM11/ELPLM07	Minimum	Projection distance (cm)= Projection screen size (inches) x 10.93-23.72
	Maximum	Projection distance (cm)= Projection screen size (inches) x 16.49-23.49
ELPLL08/ELPLL07	Minimum	Projection distance (cm)= Projection screen size (inches) x 16.20-31.95
	Maximum	Projection distance (cm)= Projection screen size (inches) x 22.60-31.66
ELPLR04	-	Projection distance (cm)= Projection screen size (inches) x 2.16-6.15

Distance from the center of the lens to the base of the screen (except for ELPLR04): ㉔ (+) (cm) = screen size (inches) x 0.26

㉔ (-) (cm) = screen size (inches) x 1.60

Distance from the center of the lens to the base of the screen (for ELPLR04): ㉔ (+)/(-) (cm) = screen size (inches) x 0.67

Projection Distance Formulas

The projection distances are approximate values.

The ELPLR04 does not support lens shift.

Visit the following Web site to find the throw distance calculator.

<http://www.epson.com/>

EB-G7905U/EB-G7900U/EB-G7500U/EB-G7400U/EB-G7200W/EB-G7000W

<For screens with an aspect ratio of 16:10>

[Units: cm]

① Inches (Diagonally)	② Width x Height	③										④ Except for ELPLR04
		ELPLM08	ELPLU03	ELPLU04 ELPLU02	ELPLW05	ELPLW06 ELPLW04	ELPLM09 ELPLS04	ELPLM10 ELPLM06	ELPLM11 ELPLM07	ELPLL08	ELPLR04	
50	108 x 67	153-248	-	91-111	109-155	172-235	229-372	352-538	511-784	761-1074	100	-79-+12
55	118 x 74	169-273	-	101-122	120-171	189-259	252-410	388-594	565-864	841-1185	110	-87-+13
60	129 x 81	185-298	-	111-134	132-187	207-284	276-447	425-649	618-945	920-1295	121	-95-+14
65	140 x 88	200-324	-	120-146	143-203	225-308	299-485	461-704	672-1026	999-1406	132	-103-+15
70	151x94	216-349	-	130-157	155-219	243-332	323-523	498-759	725-1106	1079-1516	142	-111-+17
75	162 x 101	232-374	-	140-169	167-235	261-357	347-561	534-814	779-1187	1158-1627	153	-119-+18
80	172 x 108	248-399	111-134	149-181	178-251	279-381	370-599	571-869	832-1268	1237-1737	163	-127-+19
85	183 x 114	264-425	118-143	159-192	190-267	297-405	394-637	607-925	886-1348	1317-1848	174	-135-+20
90	194 x 121	280-450	125-151	169-204	202-283	315-430	418-675	644-980	939-1429	1396-1959	184	-143-+21
95	205 x 128	295-475	133-160	179-216	213-299	332-454	441-713	680-1035	993-1510	1475-2069	195	-150-+23
100	215 x 135	311-500	140-168	188-227	225-315	350-478	465-751	717-1090	1046-1591	1555-2180	206	-158-+24
105	226 x 141	327-526	147-177	198-239	236-331	368-503	489-789	753-1145	1100-1671	1634-2290	216	-166-+25
110	237 x 148	343-551	154-186	208-251	248-347	386-527	512-827	790-1200	1153-1752	1713-2401	227	-174-+26
115	248 x 155	359-576	161-194	217-262	260-363	404-551	536-865	826-1255	1207-1833	1793-2511	237	-182-+27
120	258 x 162	374-601	169-203	227-274	271-379	422-576	560-903	863-1311	1260-1913	1827-2622	248	-190-+29
125	269 x 168	390-627	176-212	237-286	283-395	440-600	583-941	899-1366	1314-1994	1951-2733	259	-198-+30
130	280 x 175	406-652	183-220	246-297	295-411	458-624	607-979	936-1421	1367-2075	2103-2843	269	-206-+31
135	291 x 182	422-677	190-229	256-309	306-427	476-649	631-1017	972-1476	1421-2155	2110-2954	280	-214-+32
140	302 x 188	438-702	197-237	266-321	318-443	493-673	654-1055	1009-1531	1474-2236	2189-3064	290	-222-+33
145	312 x 195	453-728	204-246	276-332	329-459	511-697	678-1093	1045-1586	1528-2317	2269-3175	301	-230-+34
150	323 x 202	469-753	212-255	285-344	341-475	529-722	702-1131	1082-1641	1581-2398	2348-3285	312	-238-+36
155	334 x 209	485-778	219-263	295-355	353-491	547-746	725-1169	1118-1697	1635-2478	2427-3396	322	-245-+37
160	345 x 215	501-803	226-272	305-367	364-507	565-770	749-1206	1155-1752	1688-2559	2507-3507	333	-253-+38
165	355 x 222	517-829	233-280	314-379	376-523	583-795	772-1244	1191-1807	1742-2640	2586-3617	343	-261-+39
170	366 x 229	532-854	240-289	324-390	387-539	601-819	796-1282	1228-1862	1795-2720	2665-3728	354	-269-+40
175	377 x 236	548-879	248-298	334-402	399-555	619-843	820-1320	1264-1917	1849-2801	2745-3838	365	-277-+42
180	388 x 242	564-904	255-306	343-414	411-571	636-868	843-1358	1301-1972	1902-2882	2824-3949	375	-285-+43
185	398 x 249	580-930	262-315	353-425	422-587	654-892	867-1396	1337-2028	1956-2962	2903-4059	386	-293-+44
190	409 x 256	596-955	269-323	363-437	434-603	672-916	891-1434	1374-2083	2009-3043	2983-4170	396	-301-+45
195	420 x 263	611-980	276-332	373-449	446-619	690-941	914-1472	1410-2138	2063-3124	3062-4281	407	-309-+46
200	431 x 269	627-1005	283-341	382-460	457-636	708-965	938-1510	1447-2193	2116-3205	3141-4391	417	-317-+48
205	442 x 276	643-1031	291-349	392-472	469-652	726-989	962-1548	1483-2248	2170-3285	3221-4502	428	-325-+49
210	452 x 283	659-1056	298-358	402-484	480-668	744-1014	985-1586	1520-2303	2223-3366	3300-4612	439	-333-+50
215	463 x 289	675-1081	305-366	411-495	492-684	762-1038	1009-1624	1556-2358	2277-3447	3379-4723	449	-341-+51
220	474 x 296	691-1106	312-375	421-507	504-700	780-1062	1033-1662	1593-2414	2330-3527	3459-4833	460	-348-+52
225	485 x 303	706-1132	319-384	431-519	515-716	797-1087	1056-1700	1629-2469	2384-3608	3538-4944	470	-356-+53
230	495 x 310	722-1157	327-392	440-530	527-732	815-1111	1080-1738	1666-2524	2437-3689	3617-5054	481	-364-+55
235	506 x 316	738-1182	334-401	450-542	539-748	833-1135	1104-1776	1702-2579	2491-3769	3697-5165	492	-372-+56
240	517 x 323	754-1207	341-409	460-554	550-764	851-1160	1127-1814	1739-2634	2544-3850	3776-5276	502	-380-+57
245	528 x 330	770-1232	348-418	470-565	562-780	869-1184	1151-1852	1775-2689	2598-3931	3855-5386	513	-388-+58
250	538 x 337	785-1258	355-427	479-577	573-796	887-1208	1175-1890	1812-2744	2651-4012	3935-5497	523	-396-+59
255	549 x 343	801-1283	362-435	489-588	585-812	905-1233	1198-1928	1848-2800	2705-4092	4014-5607	534	-404-+61
260	560 x 350	817-1308	370-444	499-600	597-828	923-1257	1222-1965	1885-2855	2758-4173	4093-5718	545	-412-+62
265	571 x 357	833-1333	377-452	508-612	608-844	941-1281	1245-2003	1921-2910	2812-4254	4173-5828	555	-420-+63
270	582 x 363	849-1359	384-461	518-623	620-860	958-1306	1269-2041	1958-2965	2865-4334	4252-5939	566	-428-+64
275	592 x 370	864-1384	391-470	528-635	632-876	976-1330	1293-2079	1994-3020	2919-4415	4331-6050	576	-436-+65
280	603 x 377	880-1409	398-478	537-647	643-892	994-1354	1316-2117	2031-3075	2972-4496	4411-6160	587	-443-+67
285	614 x 384	896-1434	405-487	547-658	655-908	1012-1379	1340-2155	2067-3131	3026-4576	4490-6271	597	-451-+68
290	625 x 390	912-1460	413-495	557-670	666-924	1030-1403	1364-2193	2104-3186	3079-4657	4569-6381	608	-459-+69

①	②	③										④
Inches (Diagonally)	Width x Height	ELPLM08	ELPLU03	ELPLU04 ELPLU02	ELPLW05	ELPLW06 ELPLW04	ELPLM09 ELPLS04	ELPLM10 ELPLM06	ELPLM11 ELPLM07	ELPLL08	ELPLR04	Except for ELPLR04
295	635 x 397	928 - 1485	420 - 504	567 - 682	678 - 940	1048 - 1427	1387 - 2231	2140 - 3241	3133 - 4738	4649 - 6492	619	-467 +70
300	646 x 404	943 - 1510	427 - 513	576 - 693	690 - 956	1066 - 1452	1411 - 2269	2177 - 3296	3186 - 4819	4728 - 6602	629	-475 +71

<For screens with an aspect ratio of 16:9>

[Units: cm]

①	②	③										④
Inches (Diagonally)	Width x Height	ELPLM08	ELPLU03	ELPLU04 ELPLU02	ELPLW05	ELPLW06 ELPLW04	ELPLM09 ELPLS04	ELPLM10 ELPLM06	ELPLM11 ELPLM07	ELPLL08	ELPLR04	Except for ELPLR04
49	109 x 61	154 - 250	-	92 - 112	109 - 156	173 - 237	230 - 374	355 - 542	515 - 789	767 - 1082	101	-76 +15
50	111 x 62	157 - 255	-	94 - 114	112 - 159	176 - 242	235 - 382	362 - 554	526 - 806	784 - 1105	103	-78 +16
55	122 x 69	174 - 281	-	104 - 126	124 - 175	195 - 267	259 - 421	400 - 611	581 - 889	865 - 1218	114	-86 +17
60	133 x 75	190 - 307	-	114 - 138	136 - 192	213 - 292	284 - 460	437 - 667	636 - 972	947 - 1332	124	-94 +19
65	144 x 81	206 - 333	-	124 - 150	148 - 208	232 - 317	308 - 499	475 - 724	691 - 1055	1028 - 1446	135	-101 +20
70	155 x 87	222 - 359	-	134 - 162	160 - 225	250 - 342	332 - 538	512 - 781	746 - 1138	1110 - 1559	146	-109 +22
75	166 x 93	239 - 385	-	144 - 174	172 - 241	268 - 367	357 - 577	550 - 837	801 - 1221	1191 - 1673	157	-117 +24
80	177 x 100	255 - 411	114 - 138	154 - 186	183 - 258	287 - 392	381 - 616	587 - 894	856 - 1304	1273 - 1787	168	-125 +25
85	188 x 106	271 - 437	122 - 147	164 - 198	195 - 274	305 - 417	405 - 655	625 - 951	911 - 1387	1354 - 1900	179	-132 +27
90	199 x 112	287 - 463	129 - 156	174 - 210	207 - 291	324 - 442	430 - 694	662 - 1007	966 - 1470	1436 - 2014	190	-140 +28
95	210 x 118	304 - 488	136 - 164	184 - 222	219 - 307	342 - 467	454 - 733	700 - 1064	1021 - 1552	1517 - 2128	201	-148 +30
100	221 x 125	320 - 514	144 - 173	194 - 234	231 - 324	360 - 492	478 - 772	737 - 1121	1076 - 1635	1599 - 2241	212	-156 +31
105	232 x 131	336 - 540	151 - 182	204 - 246	243 - 340	379 - 517	502 - 811	775 - 1177	1131 - 1718	1680 - 2355	222	-164 +33
110	244 x 137	352 - 566	159 - 191	214 - 258	255 - 357	397 - 542	527 - 850	812 - 1234	1186 - 1801	1762 - 2469	233	-171 +34
115	255 x 143	369 - 592	166 - 200	224 - 270	267 - 373	415 - 567	551 - 889	850 - 1291	1241 - 1884	1844 - 2582	244	-179 +36
120	266 x 149	385 - 618	173 - 209	234 - 282	279 - 390	434 - 592	575 - 928	887 - 1347	1296 - 1967	1925 - 2696	255	-187 +38
125	277 x 156	401 - 644	181 - 217	244 - 294	291 - 406	452 - 617	600 - 967	925 - 1404	1351 - 2050	2007 - 2809	266	-195 +39
130	288 x 162	417 - 670	188 - 226	253 - 306	303 - 423	471 - 642	624 - 1006	962 - 1461	1406 - 2133	2088 - 2923	277	-203 +41
135	299 x 168	434 - 696	195 - 235	263 - 318	315 - 439	489 - 667	648 - 1045	1000 - 1517	1461 - 2216	2170 - 3037	288	-210 +42
140	310 x 174	450 - 722	203 - 244	273 - 330	327 - 456	507 - 692	673 - 1084	1037 - 1574	1516 - 2299	2251 - 3150	299	-218 +44
145	321 x 181	466 - 748	210 - 253	283 - 342	339 - 472	526 - 717	697 - 1123	1075 - 1631	1571 - 2382	2333 - 3264	310	-226 +45
150	332 x 187	482 - 774	218 - 262	293 - 354	351 - 489	544 - 742	721 - 1162	1112 - 1687	1626 - 2465	2414 - 3378	320	-234 +47
155	343 x 193	499 - 800	225 - 271	303 - 366	363 - 505	562 - 767	746 - 1201	1150 - 1744	1681 - 2548	2496 - 3491	331	-242 +49
160	354 x 199	515 - 826	232 - 279	313 - 377	375 - 522	581 - 792	770 - 1240	1187 - 1801	1736 - 2631	2577 - 3605	342	-249 +50
165	365 x 205	531 - 852	240 - 288	323 - 389	387 - 538	599 - 817	794 - 1279	1225 - 1858	1791 - 2714	2659 - 3719	353	-257 +52
170	376 x 212	547 - 878	247 - 297	333 - 401	398 - 554	618 - 842	818 - 1318	1262 - 1914	1846 - 2797	2740 - 3832	364	-265 +53
175	387 x 218	564 - 904	255 - 306	343 - 413	410 - 571	636 - 867	843 - 1357	1300 - 1971	1901 - 2880	2822 - 3946	375	-273 +55
180	398 x 224	580 - 930	262 - 315	353 - 425	422 - 587	654 - 892	867 - 1396	1337 - 2028	1956 - 2963	2963 - 4059	386	-281 +56
185	410 x 230	596 - 956	269 - 324	363 - 437	434 - 604	673 - 917	891 - 1435	1375 - 2084	2011 - 3045	2985 - 4173	397	-288 +58
190	421 x 237	612 - 981	277 - 332	373 - 449	446 - 620	691 - 942	916 - 1474	1413 - 2141	2066 - 3128	3067 - 4287	407	-296 +60
195	432 x 243	629 - 1007	284 - 341	383 - 461	458 - 637	710 - 967	940 - 1513	1450 - 2198	2121 - 3211	3148 - 4400	418	-304 +61
200	443 x 249	645 - 1033	291 - 350	393 - 473	470 - 653	728 - 992	964 - 1552	1488 - 2254	2176 - 3294	3230 - 4514	429	-312 +63
205	454 x 255	661 - 1059	299 - 359	403 - 485	482 - 670	746 - 1017	989 - 1591	1525 - 2311	2231 - 3377	3311 - 4628	440	-320 +64
210	465 x 262	677 - 1085	306 - 368	413 - 497	494 - 686	765 - 1046	1013 - 1630	1563 - 2368	2286 - 3460	3393 - 4741	451	-327 +66
215	476 x 268	694 - 1111	314 - 377	423 - 509	506 - 703	783 - 1067	1037 - 1669	1600 - 2424	2341 - 3543	3474 - 4855	462	-335 +67
220	487 x 274	710 - 1137	321 - 386	433 - 521	518 - 719	801 - 1092	1062 - 1708	1638 - 2481	2396 - 3626	3556 - 4969	473	-343 +69
225	498 x 280	726 - 1163	328 - 394	443 - 533	530 - 736	820 - 1117	1086 - 1747	1675 - 2538	2451 - 3709	3637 - 5082	484	-351 +71
230	509 x 286	742 - 1189	336 - 403	453 - 545	542 - 752	838 - 1142	1110 - 1786	1713 - 2594	2506 - 3792	3719 - 5196	495	-358 +72
235	520 x 293	759 - 1215	343 - 412	463 - 557	554 - 769	857 - 1167	1134 - 1825	1750 - 2651	2561 - 3875	3800 - 5310	505	-366 +74
240	531 x 299	775 - 1241	350 - 421	473 - 569	566 - 785	875 - 1192	1159 - 1864	1788 - 2708	2616 - 3958	3882 - 5423	516	-374 +75
245	542 x 305	791 - 1267	358 - 430	483 - 581	578 - 802	893 - 1217	1183 - 1903	1825 - 2764	2671 - 4041	3963 - 5537	527	-382 +77
250	553 x 311	807 - 1293	365 - 439	493 - 593	590 - 818	912 - 1242	1207 - 1942	1863 - 2821	2726 - 4124	4045 - 5650	538	-390 +78
255	565 x 318	824 - 1319	373 - 447	503 - 605	602 - 835	930 - 1267	1232 - 1981	1900 - 2878	2781 - 4207	4127 - 5764	549	-397 +80
260	576 x 324	840 - 1345	380 - 456	513 - 617	613 - 851	948 - 1292	1256 - 2020	1938 - 2935	2836 - 4290	4208 - 5878	560	-405 +81
265	587 x 330	856 - 1371	387 - 465	523 - 629	625 - 868	967 - 1317	1280 - 2059	1975 - 2991	2891 - 4373	4290 - 5991	571	-413 +83
270	598 x 336	872 - 1397	395 - 474	533 - 641	637 - 884	985 - 1342	1305 - 2098	2013 - 3048	2946 - 4455	4371 - 6105	582	-421 +85
275	609 x 342	889 - 1423	402 - 483	543 - 653	649 - 901	1004 - 1367	1329 - 2137	2050 - 3105	3001 - 4538	4453 - 6219	592	-429 +86
280	620 x 349	905 - 1449	409 - 492	553 - 665	661 - 917	1022 - 1392	1353 - 2176	2088 - 3161	3056 - 4621	4534 - 6332	603	-436 +88

①	②	③										④
Inches (Diagonally)	Width x Height	ELPLM08	ELPLU03	ELPLU04 ELPLU02	ELPLW05	ELPLW06 ELPLW04	ELPLM09 ELPLS04	ELPLM10 ELPLM06	ELPLM11 ELPLM07	ELPLL08	ELPLR04	Except for ELPLR04
285	631 x 355	921 - 1474	417 - 501	563 - 677	673 - 933	1040 - 1417	1378 - 2215	2125 - 3218	3111 - 4704	4616 - 6446	614	-444 - +89
290	642 x 361	937 - 1500	424 - 509	573 - 689	685 - 950	1059 - 1442	1402 - 2254	2163 - 3275	3166 - 4787	4697 - 6560	625	-452 - +91

<For screens with an aspect ratio of 4:3>

[Units: cm]

①	②	③										④
Inches (Diagonally)	Width x Height	ELPLM08	ELPLU03	ELPLU04 ELPLU02	ELPLW05	ELPLW06 ELPLW04	ELPLM09 ELPLS04	ELPLM10 ELPLM06	ELPLM11 ELPLM07	ELPLL08	ELPLR04	Except for ELPLR04
45	91 x 69	156 - 253	-	93 - 113	111 - 158	175 - 240	233 - 379	359 - 549	521 - 799	776 - 1095	102	-81 - +12
50	102 x 76	174 - 281	-	104 - 126	124 - 176	195 - 267	260 - 422	400 - 611	582 - 890	866 - 1220	114	-90 - +13
55	112 x 84	192 - 310	-	115 - 139	137 - 194	215 - 295	287 - 465	441 - 674	643 - 981	956 - 1345	126	-99 - +15
60	122 x 91	210 - 338	-	126 - 153	150 - 212	236 - 322	313 - 508	483 - 736	703 - 1073	1046 - 1470	138	-108 - +16
65	132 x 99	228 - 367	-	137 - 166	163 - 230	256 - 350	340 - 551	524 - 799	764 - 1164	1136 - 1596	150	-117 - +17
70	142 x 107	246 - 396	-	148 - 179	177 - 248	276 - 377	367 - 594	565 - 861	824 - 1256	1225 - 1721	162	-126 - +19
75	152 x 114	263 - 424	118 - 143	159 - 192	190 - 266	296 - 405	394 - 637	607 - 924	885 - 1347	1315 - 1846	174	-134 - +20
80	163 x 122	281 - 453	126 - 152	170 - 205	203 - 285	317 - 432	420 - 679	648 - 986	945 - 1438	1405 - 1971	186	-143 - +22
85	173 x 130	299 - 481	134 - 162	181 - 219	216 - 303	337 - 460	447 - 722	689 - 1048	1006 - 1530	1495 - 2096	198	-152 - +23
90	183 x 137	317 - 510	143 - 172	192 - 232	229 - 321	357 - 488	474 - 765	731 - 1111	1067 - 1621	1585 - 2221	210	-161 - +24
95	193 x 145	335 - 539	151 - 181	203 - 245	242 - 339	377 - 515	501 - 808	772 - 1173	1127 - 1712	1675 - 2347	222	-170 - +26
100	203 x 152	353 - 567	159 - 191	214 - 258	255 - 357	398 - 543	527 - 851	813 - 1236	1188 - 1804	1764 - 2472	234	-179 - +27
105	213 x 160	371 - 596	167 - 201	225 - 271	269 - 375	418 - 570	554 - 894	855 - 1298	1248 - 1895	1854 - 2597	246	-188 - +28
110	224 x 168	389 - 624	175 - 211	236 - 284	282 - 394	438 - 598	581 - 937	896 - 1361	1309 - 1986	1944 - 2722	258	-197 - +30
115	234 x 175	407 - 653	183 - 220	247 - 298	295 - 412	458 - 625	608 - 980	937 - 1423	1369 - 2078	2034 - 2847	270	-206 - +31
120	244 x 183	424 - 681	191 - 230	258 - 311	308 - 430	479 - 653	635 - 1023	979 - 1485	1430 - 2169	2124 - 2972	282	-215 - +32
125	254 x 191	442 - 710	199 - 240	269 - 324	321 - 448	499 - 680	661 - 1066	1020 - 1548	1490 - 2260	2213 - 3098	294	-224 - +34
130	264 x 198	460 - 739	208 - 250	280 - 337	334 - 466	519 - 708	688 - 1109	1061 - 1610	1551 - 2352	2303 - 3223	306	-233 - +35
135	274 x 206	478 - 767	216 - 259	291 - 350	348 - 484	539 - 736	715 - 1152	1103 - 1673	1612 - 2443	2393 - 3348	318	-242 - +36
140	284 x 213	496 - 796	224 - 269	302 - 364	361 - 502	560 - 763	742 - 1195	1144 - 1735	1672 - 2535	2483 - 3473	330	-251 - +38
145	295 x 221	514 - 824	232 - 279	313 - 377	374 - 521	580 - 791	768 - 1238	1185 - 1798	1733 - 2626	2573 - 3598	342	-260 - +39
150	305 x 229	532 - 853	240 - 289	324 - 390	387 - 539	600 - 818	795 - 1281	1227 - 1860	1793 - 2717	2662 - 3724	354	-269 - +40
155	315 x 236	550 - 881	248 - 298	335 - 403	400 - 557	620 - 846	822 - 1324	1268 - 1922	1854 - 2809	2752 - 3849	366	-278 - +42
160	325 x 244	568 - 910	256 - 308	346 - 416	413 - 575	641 - 873	849 - 1367	1309 - 1985	1914 - 2900	2842 - 3974	377	-287 - +43
165	335 x 251	586 - 939	264 - 318	357 - 430	427 - 593	661 - 901	876 - 1410	1351 - 2047	1975 - 2991	2932 - 4099	389	-296 - +44
170	345 x 259	603 - 967	273 - 328	368 - 443	440 - 611	681 - 928	902 - 1453	1392 - 2110	2036 - 3083	3022 - 4224	401	-305 - +46
175	356 x 267	621 - 996	281 - 337	379 - 456	453 - 629	701 - 956	929 - 1496	1433 - 2172	2096 - 3174	3111 - 4349	413	-314 - +47
180	366 x 274	639 - 1024	289 - 347	390 - 469	466 - 648	722 - 983	956 - 1539	1475 - 2235	2157 - 3265	3201 - 4475	425	-323 - +48
185	376 x 282	657 - 1053	297 - 357	401 - 482	479 - 666	742 - 1011	983 - 1582	1516 - 2297	2217 - 3357	3291 - 4600	437	-332 - +50
190	386 x 290	675 - 1082	305 - 367	412 - 495	492 - 684	762 - 1039	1009 - 1625	1557 - 2359	2278 - 3448	3381 - 4725	449	-341 - +51
195	396 x 297	693 - 1110	313 - 376	423 - 509	505 - 702	782 - 1066	1036 - 1668	1598 - 2422	2338 - 3540	3471 - 4850	461	-350 - +52
200	406 x 305	711 - 1139	321 - 386	434 - 522	519 - 720	803 - 1094	1063 - 1711	1640 - 2484	2399 - 3631	3561 - 4975	473	-359 - +54
205	417 x 312	729 - 1167	329 - 396	445 - 535	532 - 738	823 - 1121	1090 - 1754	1681 - 2547	2460 - 3722	3650 - 5100	485	-368 - +55
210	427 x 320	747 - 1196	338 - 406	455 - 548	545 - 757	843 - 1149	1116 - 1796	1722 - 2609	2520 - 3814	3740 - 5226	497	-377 - +56
215	437 x 328	765 - 1224	346 - 415	466 - 561	558 - 775	863 - 1176	1143 - 1839	1764 - 2672	2581 - 3905	3830 - 5351	509	-385 - +58
220	447 x 335	782 - 1253	354 - 425	477 - 575	571 - 793	883 - 1204	1170 - 1882	1805 - 2734	2641 - 3996	3920 - 5476	521	-394 - +59
225	457 x 343	800 - 1282	362 - 435	488 - 588	584 - 811	904 - 1231	1197 - 1925	1846 - 2797	2702 - 4088	4010 - 5601	533	-403 - +61
230	467 x 351	818 - 1310	370 - 445	499 - 601	598 - 829	924 - 1259	1224 - 1968	1888 - 2859	2762 - 4179	4099 - 5726	545	-412 - +62
235	478 x 358	836 - 1339	378 - 454	510 - 614	611 - 847	944 - 1286	1250 - 2011	1929 - 2921	2823 - 4270	4189 - 5851	557	-421 - +63
240	488 x 366	854 - 1367	386 - 464	521 - 627	624 - 865	964 - 1314	1277 - 2054	1970 - 2984	2884 - 4362	4279 - 5977	569	-430 - +65
245	498 x 373	872 - 1396	395 - 474	532 - 641	637 - 884	985 - 1342	1304 - 2097	2012 - 3046	2944 - 4453	4369 - 6102	581	-439 - +66
250	508 x 381	890 - 1424	403 - 483	543 - 654	650 - 902	1005 - 1369	1331 - 2140	2053 - 3109	3005 - 4544	4459 - 6227	593	-448 - +67
255	518 x 389	908 - 1453	411 - 493	554 - 667	663 - 920	1025 - 1397	1357 - 2183	2094 - 3171	3065 - 4636	4548 - 6352	605	-457 - +69
260	528 x 396	926 - 1482	419 - 503	565 - 680	676 - 938	1045 - 1424	1384 - 2226	2136 - 3234	3126 - 4727	4638 - 6477	617	-466 - +70
265	538 x 404	943 - 1510	427 - 513	576 - 693	690 - 956	1066 - 1452	1411 - 2269	2177 - 3296	3186 - 4819	4728 - 6602	629	-475 - +71

EB-G7905U/EB-G7900U/EB-G7500U/EB-G7400U/EB-G7200W/EB-G7000W (ELPLX01 is installed)

<For screens with an aspect ratio of 16:10>

[Units: cm]

①	②	③	④
Inches (Diagonally)	Width x Height	ELPLX01	ELPLX01
100	215x135	74	0 - +24
105	226x141	77	0 - +25
110	237x148	81	0 - +26
115	248x155	85	0 - +27
120	258x162	89	0 - +29
125	269x168	93	0 - +30
130	280x175	97	0 - +31
135	291x182	101	0 - +32
140	302x188	105	0 - +33
145	312x195	109	0 - +34
150	323x202	113	0 - +36
155	334x209	117	0 - +37
160	345x215	121	0 - +38
165	355x222	125	0 - +39
170	366x229	129	0 - +40
175	377x236	133	0 - +42
180	388x242	137	0 - +43
185	398x249	140	0 - +44
190	409x256	144	0 - +45
195	420x263	148	0 - +46
200	431x269	152	0 - +48
205	442x276	156	0 - +49
210	452x283	160	0 - +50
215	463x289	164	0 - +51
220	474x296	168	0 - +52
225	485x303	172	0 - +53
230	495x310	176	0 - +55
235	506x316	180	0 - +56
240	517x323	184	0 - +57
245	528x330	188	0 - +58
250	538x337	192	0 - +59
255	549x343	196	0 - +61
260	560x350	200	0 - +62
265	571x357	203	0 - +63
270	582x363	207	0 - +64
275	592x370	211	0 - +65
280	603x377	215	0 - +67
285	614x384	219	0 - +68
290	625x390	223	0 - +69
295	635x397	227	0 - +70
300	646x404	231	0 - +71
305	657x411	235	0 - +72
310	668x417	239	0 - +74
315	678x424	243	0 - +75
320	689x431	247	0 - +76
325	700x438	251	0 - +77
330	711x444	255	0 - +78
335	722x451	259	0 - +80
340	732x458	262	0 - +81
345	743x464	266	0 - +82
350	754x471	270	0 - +83
355	765x478	274	0 - +84
360	775x485	278	0 - +86
365	786x491	282	0 - +87
370	797x498	286	0 - +88
375	808x505	290	0 - +89
380	818x512	294	0 - +90
385	829x518	298	0 - +91

①	②	③	④
Inches (Diagonally)	Width x Height	ELPLX01	ELPLX01
390	840x525	302	0 - +93
395	851x532	306	0 - +94
400	862x538	310	0 - +95

<For screens with an aspect ratio of 16:9> [Units: cm]

①	②	③	④
Inches (Diagonally)	Width x Height	ELPLX01	ELPLX01
100	221x125	76	7 - +31
105	232x131	80	7 - +33
110	244x137	84	8 - +34
115	255x143	88	8 - +36
120	266x149	92	8 - +38
125	277x156	96	9 - +39
130	288x162	100	9 - +41
135	299x168	104	9 - +42
140	310x174	108	10 - +44
145	321x181	112	10 - +45
150	332x187	116	10 - +47
155	343x193	120	11 - +49
160	354x199	124	11 - +50
165	365x205	128	11 - +52
170	376x212	132	12 - +53
175	387x218	136	12 - +55
180	398x224	140	12 - +56
185	410x230	145	13 - +58
190	421x237	149	13 - +60
195	432x243	153	13 - +61
200	443x249	157	14 - +63
205	454x255	161	14 - +64
210	465x262	165	15 - +66
215	476x268	169	15 - +67
220	487x274	173	15 - +69
225	498x280	177	16 - +71
230	509x286	181	16 - +72
235	520x293	185	16 - +74
240	531x299	189	17 - +75
245	542x305	193	17 - +77
250	553x311	197	17 - +78
255	565x318	201	18 - +80
260	576x324	205	18 - +81
265	587x330	209	18 - +83
270	598x336	213	19 - +85
275	609x342	217	19 - +86
280	620x349	221	19 - +88
285	631x355	225	20 - +89
290	642x361	229	20 - +91
295	653x367	234	20 - +92
300	664x374	238	21 - +94
305	675x380	242	21 - +96
310	686x386	246	21 - +97
315	697x392	250	22 - +99
320	708x398	254	22 - +100
325	719x405	258	22 - +102
330	731x411	262	23 - +103
335	742x417	266	23 - +105
340	753x423	270	24 - +107
345	764x430	274	24 - +108
350	775x436	278	24 - +110
355	786x442	282	25 - +111
360	797x448	286	25 - +113
365	808x455	290	25 - +114
370	819x461	294	26 - +116

①	②	③	④
Inches (Diagonally)	Width x Height	ELPLX01	ELPLX01
375	830x467	298	26 - +118
380	841x473	302	26 - +119
385	852x479	306	27 - +121

<For screens with an aspect ratio of 4:3>

[Units: cm]

①	②	③	④
Inches (Diagonally)	Width x Height	ELPLX01	ELPLX01
90	183x137	75	0 - +24
95	193x145	80	0 - +26
100	203x152	84	0 - +27
105	213x160	88	0 - +28
110	224x168	93	0 - +30
115	234x175	97	0 - +31
120	244x183	102	0 - +32
125	254x191	106	0 - +34
130	264x198	111	0 - +35
135	274x206	115	0 - +36
140	284x213	120	0 - +38
145	295x221	124	0 - +39
150	305x229	129	0 - +40
155	315x236	133	0 - +42
160	325x244	137	0 - +43
165	335x251	142	0 - +44
170	345x259	146	0 - +46
175	356x267	151	0 - +47
180	366x274	155	0 - +48
185	376x282	160	0 - +50
190	386x290	164	0 - +51
195	396x297	169	0 - +52
200	406x305	173	0 - +54
205	417x312	178	0 - +55
210	427x320	182	0 - +56
215	437x328	186	0 - +58
220	447x335	191	0 - +59
225	457x343	195	0 - +61
230	467x351	200	0 - +62
235	478x358	204	0 - +63
240	488x366	209	0 - +65
245	498x373	213	0 - +66
250	508x381	218	0 - +67
255	518x389	222	0 - +69
260	528x396	227	0 - +70
265	538x404	231	0 - +71
270	549x411	235	0 - +73
275	559x419	240	0 - +74
280	569x427	244	0 - +75
285	579x434	249	0 - +77
290	589x442	253	0 - +78
295	599x450	258	0 - +79
300	610x457	262	0 - +81
305	620x465	267	0 - +82
310	630x472	271	0 - +83
315	640x480	276	0 - +85
320	650x488	280	0 - +86
325	660x495	284	0 - +87
330	671x503	289	0 - +89
335	681x511	293	0 - +90
340	691x518	298	0 - +91
345	701x526	302	0 - +93
350	711x533	307	0 - +94

EB-G7805/EB-G7800/EB-G7100

<For screens with an aspect ratio of 4:3>

[Units: cm]

①	②	③										④
Inches (Diagonally)	Width x Height	ELPLM08	ELPLU03	ELPLU04 ELPLU02	ELPLW05	ELPLW06 ELPLW04	ELPLM09 ELPLS04	ELPLM10 ELPLM06	ELPLM11 ELPLM07	ELPLL08	ELPLR04	Except for ELPLR04
50	102 x 76	147 - 239	-	88 - 107	104 - 149	165 - 227	219 - 358	338 - 519	492 - 755	732 - 1034	96	-82 + 6
55	112 x 84	162 - 263	-	97 - 118	115 - 164	182 - 251	242 - 395	374 - 572	543 - 832	809 - 1141	106	-90 + 6
60	122 x 91	178 - 288	-	107 - 129	127 - 180	199 - 274	265 - 431	409 - 625	595 - 910	885 - 1247	116	-98 + 7
65	132 x 99	193 - 312	-	116 - 141	138 - 195	217 - 297	288 - 468	444 - 679	646 - 988	962 - 1354	127	-107 + 8
70	142 x 107	208 - 336	-	125 - 152	149 - 211	234 - 321	310 - 504	479 - 732	698 - 1066	1038 - 1461	137	-115 + 8
75	152 x 114	223 - 361	-	135 - 163	160 - 226	251 - 344	333 - 541	514 - 785	750 - 1144	1115 - 1567	147	-123 + 9
80	163 x 122	239 - 385	107 - 129	144 - 174	171 - 242	268 - 368	356 - 578	549 - 838	801 - 1221	1191 - 1674	157	-131 + 9
85	173 x 130	254 - 409	114 - 138	153 - 186	183 - 257	285 - 391	379 - 614	584 - 891	853 - 1299	1267 - 1780	167	-139 + 10
90	183 x 137	269 - 434	121 - 146	163 - 197	194 - 272	303 - 415	401 - 651	620 - 945	904 - 1377	1344 - 1887	178	-148 + 10
95	193 x 145	284 - 458	128 - 154	172 - 208	205 - 288	320 - 438	424 - 687	655 - 998	956 - 1455	1420 - 1994	188	-156 + 11
100	203 x 152	299 - 482	134 - 162	181 - 219	216 - 303	337 - 461	447 - 724	690 - 1051	1007 - 1533	1497 - 2100	198	-164 + 12
105	213 x 160	315 - 507	141 - 171	191 - 231	227 - 319	354 - 485	470 - 761	725 - 1104	1059 - 1610	1573 - 2207	208	-172 + 12
110	224 x 168	330 - 531	148 - 179	200 - 242	239 - 334	372 - 508	492 - 797	760 - 1157	1110 - 1688	1650 - 2313	218	-180 + 13
115	234 x 175	345 - 556	155 - 187	209 - 253	250 - 350	389 - 532	515 - 834	795 - 1211	1162 - 1766	1726 - 2420	229	-189 + 13
120	244 x 183	360 - 580	162 - 196	219 - 264	261 - 365	406 - 555	538 - 870	831 - 1264	1213 - 1844	1802 - 2527	239	-197 + 14
125	254 x 191	376 - 604	169 - 204	228 - 276	272 - 381	423 - 578	561 - 907	866 - 1317	1265 - 1922	1879 - 2633	249	-205 + 14
130	264 x 198	391 - 629	176 - 212	237 - 287	283 - 396	440 - 602	583 - 944	901 - 1370	1317 - 1999	1955 - 2740	259	-213 + 15
135	274 x 206	406 - 653	183 - 220	247 - 298	295 - 412	458 - 625	606 - 980	936 - 1423	1368 - 2077	2032 - 2846	269	-221 + 16
140	284 x 213	421 - 677	190 - 229	256 - 309	306 - 427	475 - 649	629 - 1017	971 - 1477	1420 - 2155	2108 - 2953	280	-230 + 16
145	295 x 221	436 - 702	197 - 237	266 - 321	317 - 442	492 - 672	652 - 1053	1006 - 1530	1471 - 2233	2185 - 3059	290	-238 + 17
150	305 x 229	452 - 726	204 - 245	275 - 332	328 - 458	509 - 696	674 - 1090	1041 - 1583	1523 - 2311	2261 - 3166	300	-246 + 17
155	315 x 236	467 - 750	210 - 254	284 - 343	339 - 473	527 - 719	697 - 1127	1077 - 1636	1574 - 2388	2338 - 3273	310	-254 + 18
160	325 x 244	482 - 775	217 - 262	294 - 354	351 - 489	544 - 742	720 - 1163	1112 - 1689	1626 - 2466	2414 - 3379	320	-262 + 19
165	335 x 251	497 - 799	224 - 270	303 - 366	362 - 504	561 - 766	743 - 1200	1147 - 1743	1677 - 2544	2490 - 3486	331	-271 + 19
170	345 x 259	513 - 823	231 - 279	312 - 377	373 - 520	578 - 789	765 - 1236	1182 - 1795	1729 - 2622	2567 - 3592	341	-279 + 20
175	356 x 267	528 - 848	238 - 287	322 - 388	384 - 535	595 - 813	788 - 1273	1217 - 1849	1781 - 2700	2643 - 3699	351	-287 + 20
180	366 x 274	543 - 872	245 - 295	331 - 399	395 - 551	613 - 836	811 - 1310	1252 - 1902	1832 - 2777	2720 - 3806	361	-295 + 21
185	376 x 282	558 - 896	252 - 303	340 - 411	407 - 566	630 - 860	834 - 1346	1287 - 1955	1884 - 2855	2796 - 3912	372	-303 + 21
190	386 x 290	573 - 921	259 - 312	350 - 422	418 - 582	647 - 883	856 - 1383	1323 - 2009	1935 - 2933	2873 - 4019	382	-312 + 22
195	396 x 297	589 - 945	266 - 320	359 - 433	429 - 597	664 - 906	879 - 1419	1358 - 2062	1987 - 3011	2949 - 4125	392	-320 + 23
200	406 x 305	604 - 969	273 - 328	368 - 444	440 - 612	682 - 930	902 - 1456	1393 - 2115	2038 - 3089	3025 - 4232	402	-328 + 23
205	417 x 312	619 - 994	279 - 337	378 - 456	451 - 628	699 - 953	925 - 1493	1428 - 2168	2090 - 3166	3102 - 4339	412	-336 + 24
210	427 x 320	634 - 1018	286 - 345	387 - 467	463 - 643	716 - 977	947 - 1529	1463 - 2221	2141 - 3244	3178 - 4445	423	-344 + 24
215	437 x 328	650 - 1042	293 - 353	396 - 478	474 - 659	733 - 1000	970 - 1566	1498 - 2275	2193 - 3322	3255 - 4552	433	-353 + 25
220	447 x 335	665 - 1067	300 - 361	406 - 489	485 - 674	751 - 1024	993 - 1602	1534 - 2328	2244 - 3400	3331 - 4658	443	-361 + 25
225	457 x 343	680 - 1091	307 - 370	415 - 501	496 - 690	768 - 1047	1016 - 1639	1569 - 2381	2296 - 3478	3408 - 4765	453	-369 + 26
230	467 x 351	695 - 1116	314 - 378	424 - 512	507 - 705	785 - 1070	1038 - 1676	1604 - 2434	2348 - 3555	3484 - 4872	463	-377 + 27
235	478 x 358	711 - 1140	321 - 386	434 - 523	519 - 721	802 - 1094	1061 - 1712	1639 - 2487	2399 - 3633	3560 - 4978	474	-385 + 27
240	488 x 366	726 - 1164	328 - 395	443 - 534	530 - 736	819 - 1117	1084 - 1749	1674 - 2541	2451 - 3711	3637 - 5085	484	-394 + 28
245	498 x 373	741 - 1189	335 - 403	453 - 546	541 - 752	837 - 1141	1107 - 1785	1709 - 2594	2502 - 3789	3713 - 5191	494	-402 + 28
250	508 x 381	756 - 1213	342 - 411	462 - 557	552 - 767	854 - 1164	1129 - 1822	1744 - 2647	2554 - 3867	3790 - 5298	504	-410 + 29
255	518 x 389	771 - 1237	349 - 420	471 - 568	563 - 782	871 - 1188	1152 - 1859	1780 - 2700	2605 - 3944	3866 - 5404	514	-418 + 30
260	528 x 396	787 - 1262	355 - 428	481 - 579	574 - 798	888 - 1211	1175 - 1895	1815 - 2753	2657 - 4022	3943 - 5511	525	-426 + 30
265	538 x 404	802 - 1286	362 - 436	490 - 591	586 - 813	906 - 1234	1198 - 1932	1850 - 2807	2708 - 4100	4019 - 5618	535	-435 + 31
270	549 x 411	817 - 1310	369 - 444	499 - 602	597 - 829	923 - 1258	1220 - 1968	1885 - 2860	2760 - 4178	4095 - 5724	545	-443 + 31
275	559 x 419	832 - 1335	376 - 453	509 - 613	608 - 844	940 - 1281	1243 - 2005	1920 - 2913	2812 - 4256	4172 - 5831	555	-451 + 32
280	569 x 427	848 - 1359	383 - 461	518 - 624	619 - 860	957 - 1305	1266 - 2042	1955 - 2966	2863 - 4333	4248 - 5937	565	-459 + 32
285	579 x 434	863 - 1383	390 - 469	527 - 636	630 - 875	974 - 1328	1289 - 2078	1990 - 3019	2915 - 4411	4325 - 6044	576	-467 + 33
290	589 x 442	878 - 1408	397 - 478	537 - 647	642 - 891	992 - 1352	1311 - 2115	2026 - 3073	2966 - 4489	4401 - 6151	586	-476 + 34
295	599 x 450	893 - 1432	404 - 486	546 - 658	653 - 906	1009 - 1375	1334 - 2151	2061 - 3126	3018 - 4567	4478 - 6257	596	-484 + 34
300	610 x 457	908 - 1456	411 - 494	555 - 669	664 - 922	1026 - 1398	1357 - 2188	2096 - 3179	3069 - 4645	4554 - 6364	606	-492 + 35

<For screens with an aspect ratio of 16:9>

[Units: cm]

①	②	③										④
Inches (Diagonally)	Width x Height	ELPLM08	ELPLU03	ELPLU04 ELPLU02	ELPLW05	ELPLW06 ELPLW04	ELPLM09 ELPLS04	ELPLM10 ELPLM06	ELPLM11 ELPLM07	ELPLL08	ELPLR04	Except for ELPLR04
46	102 x 57	148 - 240	-	88 - 107	104 - 149	165 - 228	220 - 359	339 - 520	493 - 756	734 - 1037	96	-73 +15
50	111 x 62	161 - 261	-	96 - 117	114 - 163	180 - 248	240 - 391	370 - 567	538 - 824	801 - 1130	105	-79 +17
55	122 x 69	177 - 287	-	106 - 129	126 - 179	199 - 274	265 - 431	408 - 625	594 - 909	884 - 1246	116	-87 +18
60	133 x 75	194 - 314	-	117 - 141	139 - 196	218 - 299	289 - 471	446 - 682	650 - 994	967 - 1362	127	-95 +20
65	144 x 81	211 - 340	-	127 - 154	151 - 213	237 - 325	314 - 510	485 - 740	706 - 1078	1051 - 1478	138	-103 +22
70	155 x 87	227 - 367	-	137 - 166	163 - 230	255 - 350	339 - 550	523 - 798	763 - 1163	1134 - 1594	150	-111 +23
75	166 x 93	244 - 393	109 - 132	147 - 178	175 - 247	274 - 376	364 - 590	561 - 856	819 - 1248	1217 - 1710	161	-118 +25
80	177 x 100	260 - 420	117 - 141	157 - 191	187 - 264	293 - 401	389 - 630	600 - 914	875 - 1333	1300 - 1826	172	-126 +27
85	188 x 106	277 - 446	124 - 150	168 - 203	200 - 280	312 - 427	413 - 670	638 - 972	931 - 1417	1384 - 1943	183	-134 +28
90	199 x 112	294 - 473	132 - 159	178 - 215	212 - 297	330 - 452	438 - 710	676 - 1030	987 - 1502	1467 - 2059	194	-142 +30
95	210 x 118	310 - 500	139 - 168	188 - 227	224 - 314	349 - 478	463 - 750	715 - 1088	1043 - 1587	1550 - 2175	205	-150 +32
100	221 x 125	327 - 526	147 - 177	198 - 240	236 - 331	368 - 503	488 - 790	753 - 1146	1100 - 1672	1633 - 2291	216	-158 +33
105	232 x 131	343 - 553	154 - 186	208 - 252	248 - 348	387 - 529	512 - 829	791 - 1204	1156 - 1756	1717 - 2407	227	-166 +35
110	244 x 137	360 - 579	162 - 195	218 - 264	261 - 365	405 - 554	537 - 869	829 - 1262	1212 - 1841	1800 - 2523	239	-174 +37
115	255 x 143	376 - 606	169 - 204	229 - 276	273 - 382	424 - 580	562 - 909	868 - 1320	1268 - 1926	1883 - 2639	250	-182 +38
120	266 x 149	393 - 632	177 - 213	239 - 289	285 - 398	443 - 605	587 - 949	906 - 1378	1324 - 2011	1967 - 2755	261	-189 +40
125	277 x 156	410 - 659	184 - 222	249 - 301	297 - 415	462 - 631	612 - 989	944 - 1436	1380 - 2096	2050 - 2872	272	-197 +42
130	288 x 162	426 - 685	192 - 231	259 - 313	309 - 432	481 - 656	636 - 1029	983 - 1494	1436 - 2180	2133 - 2988	283	-205 +43
135	299 x 168	443 - 712	200 - 241	269 - 325	322 - 449	499 - 682	661 - 1069	1021 - 1552	1493 - 2265	2216 - 3104	294	-213 +45
140	310 x 174	459 - 738	207 - 250	280 - 338	334 - 466	518 - 707	686 - 1109	1059 - 1610	1549 - 2350	2300 - 3220	305	-221 +47
145	321 x 181	476 - 765	215 - 259	290 - 350	346 - 483	537 - 733	711 - 1148	1097 - 1668	1605 - 2435	2383 - 3336	316	-229 +48
150	332 x 187	493 - 791	222 - 268	300 - 362	358 - 499	556 - 759	736 - 1188	1136 - 1726	1661 - 2519	2466 - 3452	327	-237 +50
155	343 x 193	509 - 818	230 - 277	310 - 374	370 - 516	574 - 784	760 - 1228	1174 - 1784	1717 - 2604	2549 - 3568	339	-245 +52
160	354 x 199	526 - 844	237 - 286	320 - 387	383 - 533	593 - 810	785 - 1268	1212 - 1842	1773 - 2689	2633 - 3684	350	-253 +53
165	365 x 205	542 - 871	245 - 295	331 - 399	395 - 550	612 - 835	810 - 1308	1251 - 1900	1830 - 2774	2716 - 3801	361	-261 +55
170	376 x 212	559 - 897	252 - 304	341 - 411	407 - 567	631 - 861	835 - 1348	1289 - 1958	1886 - 2858	2799 - 3917	372	-268 +57
175	387 x 218	575 - 924	260 - 313	351 - 423	419 - 584	649 - 886	859 - 1388	1327 - 2016	1942 - 2943	2883 - 4033	383	-276 +58
180	398 x 224	592 - 950	267 - 322	361 - 436	431 - 600	668 - 912	884 - 1428	1366 - 2074	1998 - 3028	2966 - 4149	394	-284 +60
185	410 x 230	609 - 977	275 - 331	371 - 448	444 - 617	687 - 937	909 - 1467	1404 - 2131	2054 - 3113	3049 - 4265	405	-292 +62
190	421 x 237	625 - 1004	282 - 340	381 - 460	456 - 634	706 - 963	934 - 1507	1442 - 2189	2110 - 3197	3132 - 4381	416	-300 +63
195	432 x 243	642 - 1030	290 - 349	392 - 472	468 - 651	724 - 988	959 - 1547	1480 - 2247	2167 - 3282	3216 - 4497	428	-308 +65
200	443 x 249	658 - 1057	297 - 358	402 - 485	480 - 668	743 - 1014	983 - 1587	1519 - 2305	2223 - 3367	3299 - 4613	439	-316 +67
205	454 x 255	675 - 1083	305 - 367	412 - 497	492 - 685	762 - 1039	1008 - 1627	1557 - 2363	2279 - 3452	3382 - 4730	450	-324 +68
210	465 x 262	692 - 1110	312 - 376	422 - 509	505 - 701	781 - 1065	1033 - 1667	1595 - 2421	2335 - 3536	3465 - 4846	461	-332 +70
215	476 x 268	708 - 1136	320 - 385	432 - 521	517 - 718	800 - 1090	1058 - 1707	1634 - 2479	2391 - 3621	3549 - 4962	472	-339 +72
220	487 x 274	725 - 1163	327 - 394	443 - 534	529 - 735	818 - 1116	1083 - 1747	1672 - 2537	2447 - 3706	3632 - 5078	483	-347 +73
225	498 x 280	741 - 1189	335 - 403	453 - 546	541 - 752	837 - 1141	1107 - 1786	1710 - 2595	2504 - 3791	3715 - 5194	494	-355 +75
230	509 x 286	758 - 1216	342 - 412	463 - 558	553 - 769	856 - 1167	1132 - 1826	1748 - 2653	2560 - 3876	3799 - 5310	505	-363 +77
235	520 x 293	775 - 1242	350 - 421	473 - 570	566 - 786	875 - 1192	1157 - 1866	1787 - 2711	2616 - 3960	3882 - 5426	517	-371 +78
240	531 x 299	791 - 1269	357 - 430	483 - 583	578 - 803	893 - 1218	1182 - 1906	1825 - 2769	2672 - 4045	3965 - 5542	528	-379 +80
245	542 x 305	808 - 1295	365 - 439	494 - 595	590 - 819	912 - 1243	1206 - 1946	1863 - 2827	2728 - 4130	4048 - 5659	539	-387 +82
250	553 x 311	824 - 1322	373 - 448	504 - 607	602 - 836	931 - 1269	1231 - 1986	1902 - 2885	2784 - 4215	4132 - 5775	550	-395 +83
255	565 x 318	841 - 1348	380 - 457	514 - 620	614 - 853	950 - 1294	1256 - 2026	1940 - 2943	2841 - 4299	4215 - 5891	561	-403 +85
260	576 x 324	857 - 1375	388 - 466	524 - 632	627 - 870	968 - 1320	1281 - 2065	1978 - 3001	2897 - 4384	4298 - 6007	572	-411 +87
265	587 x 330	874 - 1401	395 - 475	534 - 644	639 - 887	987 - 1346	1306 - 2105	2017 - 3059	2953 - 4469	4381 - 6123	583	-418 +88
270	598 x 336	891 - 1428	403 - 484	544 - 656	651 - 904	1006 - 1371	1330 - 2145	2055 - 3117	3009 - 4554	4465 - 6239	594	-426 +90
275	609 x 342	907 - 1454	410 - 493	555 - 669	663 - 920	1025 - 1397	1355 - 2185	2093 - 3175	3065 - 4638	4548 - 6355	605	-434 +92

<For screens with an aspect ratio of 16:10>

[Units: cm]

①	②	③										④
Inches (Diagonally)	Width x Height	ELPLM08	ELPLU03	ELPLU04 ELPLU02	ELPLW05	ELPLW06 ELPLW04	ELPLM09 ELPLS04	ELPLM10 ELPLM06	ELPLM11 ELPLM07	ELPLL08	ELPLR04	Except for ELPLR04
48	98 x 73	150 - 243	-	90 - 109	106 - 151	168 - 231	223 - 364	345 - 528	501 - 768	746 - 1053	98	-77 - +12
50	108 x 67	156 - 254	-	93 - 114	111 - 158	175 - 241	233 - 380	360 - 551	523 - 801	778 - 1098	102	-80 - +13
55	118 x 74	172 - 279	-	103 - 126	123 - 174	193 - 266	257 - 419	397 - 607	577 - 884	859 - 1211	113	-88 - +14
60	129 x 81	189 - 305	-	113 - 138	135 - 191	212 - 291	281 - 458	434 - 664	632 - 966	940 - 1324	124	-96 - +15
65	140 x 88	205 - 331	-	123 - 149	147 - 207	230 - 316	305 - 496	471 - 720	687 - 1049	1021 - 1437	135	-104 - +17
70	151 x 94	221 - 357	-	133 - 161	158 - 224	248 - 340	330 - 535	509 - 776	741 - 1131	1102 - 1550	145	-112 - +18
75	162 x 101	237 - 383	-	143 - 173	170 - 240	266 - 365	354 - 574	546 - 833	796 - 1214	1183 - 1663	156	-120 - +19
80	172 x 108	253 - 408	113 - 137	153 - 185	182 - 256	285 - 390	378 - 613	583 - 889	851 - 1296	1264 - 1776	167	-128 - +21
85	183 x 114	269 - 434	121 - 146	163 - 197	194 - 273	303 - 415	402 - 652	620 - 946	905 - 1378	1345 - 1889	178	-136 - +22
90	194 x 121	285 - 460	128 - 155	173 - 209	206 - 289	321 - 440	426 - 690	658 - 1002	960 - 1461	1426 - 2002	189	-144 - +23
95	205 x 128	302 - 486	135 - 164	183 - 221	218 - 306	340 - 465	450 - 729	695 - 1058	1014 - 1543	1507 - 2115	199	-152 - +24
100	215 x 135	318 - 512	143 - 172	193 - 233	230 - 322	358 - 489	474 - 768	732 - 1115	1069 - 1626	1588 - 2228	210	-160 - +26
105	226 x 141	334 - 537	150 - 181	202 - 245	241 - 338	376 - 514	498 - 807	769 - 1171	1124 - 1708	1669 - 2341	221	-168 - +27
110	237 x 148	350 - 563	157 - 190	212 - 257	253 - 355	394 - 539	522 - 846	807 - 1228	1178 - 1791	1750 - 2454	232	-176 - +28
115	248 x 155	366 - 589	165 - 199	222 - 269	265 - 371	413 - 564	547 - 884	844 - 1284	1233 - 1873	1832 - 2567	243	-184 - +30
120	258 x 162	382 - 615	172 - 208	232 - 281	277 - 387	431 - 589	571 - 923	881 - 1340	1288 - 1956	1913 - 2680	254	-192 - +31
125	269 x 168	398 - 641	179 - 216	242 - 293	289 - 404	449 - 614	595 - 962	918 - 1397	1342 - 2038	1994 - 2793	264	-200 - +32
130	280 x 175	415 - 667	187 - 225	252 - 304	301 - 420	467 - 638	619 - 1001	956 - 1453	1397 - 2121	2075 - 2906	275	-208 - +33
135	291 x 182	431 - 692	194 - 234	262 - 316	313 - 437	486 - 663	643 - 1040	993 - 1510	1452 - 2203	2156 - 3019	286	-216 - +35
140	302 x 188	447 - 718	201 - 243	272 - 328	325 - 453	504 - 688	667 - 1078	1030 - 1566	1506 - 2286	2237 - 3132	297	-224 - +36
145	312 x 195	463 - 744	209 - 252	282 - 340	336 - 469	522 - 713	691 - 1117	1067 - 1622	1561 - 2368	2318 - 3245	308	-233 - +37
150	323 x 202	479 - 770	216 - 260	292 - 352	348 - 486	540 - 738	715 - 1156	1105 - 1679	1616 - 2451	2399 - 3358	318	-241 - +39
155	334 x 209	495 - 796	223 - 269	302 - 364	360 - 502	559 - 763	740 - 1195	1142 - 1733	1670 - 2533	2480 - 3471	329	-249 - +40
160	345 x 215	511 - 821	231 - 278	312 - 376	372 - 518	577 - 787	764 - 1234	1179 - 1792	1725 - 2615	2561 - 3584	340	-257 - +41
165	355 x 222	528 - 847	238 - 287	321 - 388	384 - 535	595 - 812	788 - 1272	1216 - 1848	1779 - 2698	2642 - 3697	351	-265 - +42
170	366 x 229	544 - 873	245 - 295	331 - 400	396 - 551	613 - 837	812 - 1311	1254 - 1904	1834 - 2780	2723 - 3810	362	-273 - +44
175	377 x 236	560 - 899	253 - 304	341 - 412	408 - 568	632 - 862	836 - 1350	1291 - 1961	1889 - 2863	2804 - 3923	373	-281 - +45
180	388 x 242	576 - 925	260 - 313	351 - 424	420 - 584	650 - 887	860 - 1389	1328 - 2017	1943 - 2945	2885 - 4036	383	-289 - +46
185	398 x 249	592 - 950	267 - 322	361 - 436	431 - 600	668 - 912	884 - 1427	1366 - 2073	1998 - 3028	2966 - 4149	394	-297 - +48
190	409 x 256	608 - 976	275 - 331	371 - 448	443 - 617	686 - 936	908 - 1466	1403 - 2130	2053 - 3110	3047 - 4262	405	-305 - +49
195	420 x 263	624 - 1002	282 - 339	381 - 459	455 - 633	705 - 961	932 - 1505	1440 - 2186	2107 - 3193	3128 - 4375	416	-313 - +50
200	431 x 269	640 - 1028	289 - 348	391 - 471	467 - 650	723 - 986	957 - 1544	1477 - 2243	2162 - 3275	3209 - 4488	427	-321 - +51
205	442 x 276	657 - 1054	296 - 357	401 - 483	479 - 662	741 - 1011	981 - 1583	1515 - 2299	2217 - 3358	3290 - 4601	437	-329 - +53
210	452 x 283	673 - 1079	304 - 366	411 - 495	491 - 682	759 - 1036	1005 - 1621	1552 - 2355	2271 - 3440	3371 - 4714	448	-337 - +54
215	463 x 289	689 - 1105	311 - 375	421 - 507	503 - 699	778 - 1061	1029 - 1660	1589 - 2412	2326 - 3523	3452 - 4827	459	-345 - +55
220	474 x 296	705 - 1131	318 - 383	430 - 519	514 - 715	796 - 1085	1053 - 1699	1626 - 2468	2381 - 3605	3533 - 4940	470	-353 - +57
225	485 x 303	721 - 1157	326 - 392	440 - 531	526 - 731	814 - 1110	1077 - 1738	1664 - 2525	2435 - 3688	3614 - 5053	481	-361 - +58
230	495 x 310	737 - 1183	333 - 401	450 - 543	538 - 748	833 - 1135	1101 - 1777	1701 - 2581	2490 - 3770	3695 - 5166	492	-369 - +59
235	506 x 316	753 - 1209	340 - 410	460 - 555	550 - 764	851 - 1160	1125 - 1815	1738 - 2637	2544 - 3852	3776 - 5279	502	-377 - +60
240	517 x 323	770 - 1234	348 - 419	470 - 567	562 - 781	869 - 1185	1149 - 1854	1775 - 2694	2599 - 3935	3857 - 5392	513	-385 - +62
245	528 x 330	786 - 1260	355 - 427	480 - 579	574 - 797	887 - 1210	1174 - 1893	1813 - 2750	2654 - 4017	3938 - 5505	524	-393 - +63
250	538 x 337	802 - 1286	362 - 436	490 - 591	586 - 813	906 - 1234	1198 - 1932	1850 - 2807	2708 - 4100	4019 - 5618	535	-401 - +64
255	549 x 343	818 - 1312	370 - 445	500 - 603	598 - 830	924 - 1259	1222 - 1971	1887 - 2863	2763 - 4182	4100 - 5731	546	-409 - +66
260	560 x 350	834 - 1338	377 - 454	510 - 615	609 - 846	942 - 1284	1246 - 2009	1924 - 2919	2818 - 4265	4181 - 5844	556	-417 - +67
265	571 x 357	850 - 1363	384 - 462	520 - 626	621 - 863	960 - 1309	1270 - 2048	1962 - 2976	2872 - 4347	4262 - 5957	567	-425 - +68
270	582 x 363	866 - 1389	392 - 471	530 - 638	633 - 879	979 - 1334	1294 - 2087	1999 - 3032	2927 - 4430	4343 - 6070	578	-433 - +69
275	592 x 370	883 - 1415	399 - 480	539 - 650	645 - 895	997 - 1359	1318 - 2126	2036 - 3089	2982 - 4512	4424 - 6183	589	-441 - +71
280	603 x 377	899 - 1441	406 - 489	549 - 662	657 - 912	1015 - 1383	1342 - 2165	2073 - 3145	3036 - 4595	4505 - 6296	600	-449 - +72

EB-G7805/EB-G7800/EB-G7100 (ELPLX01 is installed)

<For screens with an aspect ratio of 4:3>

[Units: cm]

①	②	③	④
Inches (Diagonally)	Width x Height	ELPLX01	ELPLX01
100	203x152	71	0 - +12
105	213x160	74	0 - +12
110	224x168	78	0 - +13
115	234x175	82	0 - +13
120	244x183	86	0 - +14
125	254x191	90	0 - +14
130	264x198	93	0 - +15
135	274x206	97	0 - +16
140	284x213	101	0 - +16
145	295x221	105	0 - +17
150	305x229	109	0 - +17
155	315x236	112	0 - +18
160	325x244	116	0 - +19
165	335x251	120	0 - +19
170	345x259	124	0 - +20
175	356x267	128	0 - +20
180	366x274	131	0 - +21
185	376x282	135	0 - +21
190	386x290	139	0 - +22
195	396x297	143	0 - +23
200	406x305	147	0 - +23
205	417x312	151	0 - +24
210	427x320	154	0 - +24
215	437x328	158	0 - +25
220	447x335	162	0 - +25
225	457x343	166	0 - +26
230	467x351	170	0 - +27
235	478x358	173	0 - +27
240	488x366	177	0 - +28
245	498x373	181	0 - +28
250	508x381	185	0 - +29
255	518x389	189	0 - +30
260	528x396	192	0 - +30
265	538x404	196	0 - +31
270	549x411	200	0 - +31
275	559x419	204	0 - +32
280	569x427	208	0 - +32
285	579x434	211	0 - +33
290	589x442	215	0 - +34
295	599x450	219	0 - +34
300	610x457	223	0 - +35
305	620x465	227	0 - +35
310	630x472	230	0 - +36
315	640x480	234	0 - +36
320	650x488	238	0 - +37
325	660x495	242	0 - +38
330	671x503	246	0 - +38
335	681x511	249	0 - +39
340	691x518	253	0 - +39
345	701x526	257	0 - +40
350	711x533	261	0 - +40
355	721x541	265	0 - +41
360	732x549	268	0 - +42
365	742x556	272	0 - +42
370	752x564	276	0 - +43
375	762x572	280	0 - +43
380	772x579	284	0 - +44
385	782x587	287	0 - +45
390	792x594	291	0 - +45
395	803x602	295	0 - +46

①	②	③	④
Inches (Diagonally)	Width x Height	ELPLX01	ELPLX01
400	813x610	299	0 - +46

<For screens with an aspect ratio of 16:9>

[Units: cm]

①	②	③	④
Inches (Diagonally)	Width x Height	ELPLX01	ELPLX01
92	204x115	71	19 - +31
95	210x118	73	20 - +32
100	221x125	77	21 - +33
105	232x131	82	22 - +35
110	244x137	86	23 - +37
115	255x143	90	24 - +38
120	266x149	94	25 - +40
125	277x156	98	26 - +42
130	288x162	102	27 - +43
135	299x168	106	28 - +45
140	310x174	111	29 - +47
145	321x181	115	30 - +48
150	332x187	119	31 - +50
155	343x193	123	32 - +52
160	354x199	127	33 - +53
165	365x205	131	34 - +55
170	376x212	135	35 - +57
175	387x218	140	36 - +58
180	398x224	144	37 - +60
185	410x230	148	38 - +62
190	421x237	152	39 - +63
195	432x243	156	40 - +65
200	443x249	160	42 - +67
205	454x255	164	43 - +68
210	465x262	169	44 - +70
215	476x268	173	45 - +72
220	487x274	177	46 - +73
225	498x280	181	47 - +75
230	509x286	185	48 - +77
235	520x293	189	49 - +78
240	531x299	193	50 - +80
245	542x305	198	51 - +82
250	553x311	202	52 - +83
255	565x318	206	53 - +85
260	576x324	210	54 - +87
265	587x330	214	55 - +88
270	598x336	218	56 - +90
275	609x342	222	57 - +92
280	620x349	227	58 - +93
285	631x355	231	59 - +95
290	642x361	235	60 - +97
295	653x367	239	61 - +98
300	664x374	243	62 - +100
305	675x380	247	63 - +102
310	686x386	251	64 - +103
315	697x392	256	65 - +105
320	708x399	260	66 - +107
325	720x405	264	67 - +108
330	731x411	268	68 - +110
335	742x417	272	70 - +112
340	753x423	276	71 - +113
345	764x430	280	72 - +115
350	775x436	285	73 - +117
355	786x442	289	74 - +118
360	797x448	293	75 - +120
365	808x455	297	76 - +122
370	819x461	301	77 - +123

①	②	③	④
Inches (Diagonally)	Width x Height	ELPLX01	ELPLX01
375	830x467	305	78 - +125

<For screens with an aspect ratio of 16:10>

[Units: cm]

①	②	③	④
Inches (Diagonally)	Width x Height	ELPLX01	ELPLX01
95	205x128	71	13 - +24
100	215x135	75	13 - +26
105	226x141	79	14 - +27
110	237x148	83	15 - +28
115	248x155	87	15 - +30
120	258x162	91	16 - +31
125	269x168	95	17 - +32
130	280x175	99	18 - +33
135	291x182	103	18 - +35
140	302x188	107	19 - +36
145	312x195	111	20 - +37
150	323x202	116	20 - +39
155	334x209	120	21 - +40
160	345x215	124	22 - +41
165	355x222	128	22 - +42
170	366x229	132	23 - +44
175	377x236	136	24 - +45
180	388x242	140	24 - +46
185	398x249	144	25 - +48
190	409x256	148	26 - +49
195	420x263	152	26 - +50
200	431x269	156	27 - +51
205	442x276	160	28 - +53
210	452x283	164	28 - +54
215	463x289	168	29 - +55
220	474x296	172	30 - +57
225	485x303	176	30 - +58
230	495x310	180	31 - +59
235	506x316	184	32 - +60
240	517x323	188	32 - +62
245	528x330	192	33 - +63
250	538x337	196	34 - +64
255	549x343	200	34 - +66
260	560x350	204	35 - +67
265	571x357	208	36 - +68
270	582x363	212	36 - +69
275	592x370	216	37 - +71
280	603x377	220	38 - +72
285	614x384	224	38 - +73
290	625x390	228	39 - +75
295	635x397	232	40 - +76
300	646x404	236	40 - +77
305	657x411	240	41 - +78
310	668x417	244	42 - +80
315	678x424	249	42 - +81
320	689x431	253	43 - +82
325	700x438	257	44 - +84
330	711x444	261	44 - +85
335	722x451	265	45 - +86
340	732x458	269	46 - +87
345	743x464	273	46 - +89
350	754x471	277	47 - +90
355	765x478	281	48 - +91
360	775x485	285	48 - +93
365	786x491	289	49 - +94
370	797x498	293	50 - +95
375	808x505	297	50 - +96

■ Lens Compatibility Table

Lens Model Number	Projector Model Number		
	EB-G7905U EB-G7900U EB-G7500U EB-G7400U EB-G7200W EB-G7000W EB-G7805 EB-G7800 EB-G7100	EB-Z10005U EB-Z10000U EB-Z9875U EB-Z9870U EB-Z9750U EB-Z11000W EB-Z9900W EB-Z9800W EB-Z11005 EB-Z11000 EB-Z9870	EB-G6970WU EB-G6770WU EB-G6570WU EB-G6470WU EB-G6270W EB-G6070W EB-G6870 EB-G6370 EB-G6170
ELPLM08	○	×	×
ELPLX01*1	○	×	×
ELPLU03	○	×	×
ELPLU04	○	×	×
ELPLW05	○	×	×
ELPLW06	○	×	×
ELPLM09	○	×	×
ELPLM10	○	×	×
ELPLM11	○	×	×
ELPLL08	○	×	×
ELPLS04	○	○	×
ELPLU02*2	○	○	×
ELPLR04*3	○	○	×
ELPLW04	○	○	×
ELPLM06	○	○	×
ELPLM07	○	○	×
ELPLL07	○	○	×
ELPLS07	×	×	○
ELPLS06	×	×	○
ELPLU01	×	×	○
ELPLR03	×	×	○
ELPLM04	×	×	○
ELPLM05	×	×	○
ELPLL06	×	×	○

*1 Zoom is not supported.

*2 Manually adjust distortion.

*3 Zoom and Lens Shift are not supported.

■ Supported Resolutions

Computer signals (analog RGB)

Signal	Refresh Rate (Hz)	Resolution (Dots)
VGA	60/72/75/85	640 × 480
SVGA	60/72/75/85	800 × 600
XGA	60/70/75/85	1024 × 768
WXGA	60	1280 × 768
	60	1366 × 768
	60/75/85	1280 × 800
WXGA+	60/75/85	1440 × 900
WXGA++	60	1600 × 900
SXGA	70/75/85	1152 × 864
	60/75/85	1280 × 1024
	60/75/85	1280 × 960
SXGA+	60/75	1400 × 1050
WSXGA+ ^{*1}	60	1680 × 1050
UXGA	60	1600 × 1200
WUXGA ^{*2}	60	1920 × 1200

Component video

Signal	Refresh Rate (Hz)	Resolution (Dots)
SDTV (480i)	60	720 × 480
SDTV (576i)	50	720 × 576
SDTV (480p)	60	720 × 480
SDTV (576p)	50	720 × 576
HDTV (720p)	50/60	1280 × 720
HDTV (1080i)	50/60	1920 × 1080
HDTV (1080p) ^{*3}	50/60	1920 × 1080

*1 EB-G7905U/EB-G7900U/EB-G7500U/EB-G7400U/EB-G7200W/EB-G7000W only. Only compatible when Wide is selected as the Resolution in the Configuration menu.

*2 EB-G7905U/EB-G7900U/EB-G7500U/EB-G7400U only. Only compatible when VESA CVT-RB (Reduced Blanking) signals are being input.

*3 Only compatible when signals are being input from the Computer input port.

DVI-D/HDMI/HDBaseT

Signal	Refresh Rate (Hz)	Resolution (Dots)
VGA	60	640 × 480
SVGA	60	800 × 600
XGA	60	1024 × 768
WXGA	60	1280 × 800
	60	1366 × 768
WXGA+	60	1440 × 900
WXGA++	60	1600 × 900
WSXGA+ ^{*1}	60	1680 × 1050
SXGA	60	1280 × 960
	60	1280 × 1024
SXGA+	60	1400 × 1050

UXGA	60	1600 × 1200
WUXGA ^{*2}	60	1920 × 1200
QXGA ^{*3}	60	2048 × 1536
WQHD ^{*3}	60	2560 × 1440
WQXGA ^{*2*3}	60	2560 × 1600
SDTV (480i/480p)	60	720 × 480
SDTV (576i/576p)	50	720 × 576
HDTV (720p)	50/60	1280 × 720
HDTV (1080i)	50/60	1920 × 1080
HDTV (1080p)	24/30/50/60	1920 × 1080
4K x 2K ^{*3}	24/25/30/50/60	3840 × 2160
4K x 2K (SMPTE) ^{*3}	24/50/60	4096 × 2160

*1 EB-G7905U/EB-G7900U/EB-G7500U/EB-G7400U/EB-G7200W/EB-G7000W only.

*2 Only compatible when VESA CVT-RB (Reduced Blanking) signals are being input.

*3 EB-G7905U/EB-G7900U/EB-G7500U/EB-G7400U only. Only supports input signals from the HDMI or HDBaseT port.

■ Available Lens Shift Adjustment Range

The ranges within which the image can be moved are shown below.

The position of the projected image cannot be moved to both the horizontal and vertical maximum values.

The ELPLR04 does not support lens shift.

EB-G7905U/EB-G7900U/EB-G7500U/EB-G7400U/EB-G7200W/EB-G7000W

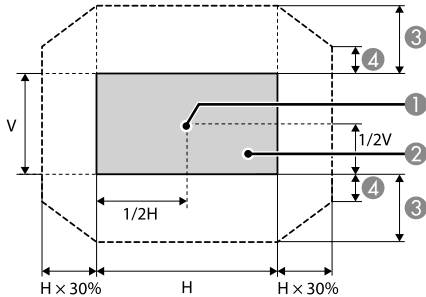

- ① Center of lens
- ② Projected image when the lens position is moved to the home position
- ③ Maximum motion range: $V \times 67\%$
- ④ When the horizontal direction is at the maximum value: $V \times 19\%$

When using the ELPLX01

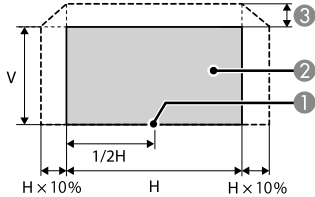

- ① Center of lens
- ② Projected image when the lens position is moved to the home position
- ③ Maximum motion range: $V \times 17\%$

* When the horizontal direction is set to the maximum, the image cannot be moved upward.

EB-G7805/EB-G7800/EB-G7100

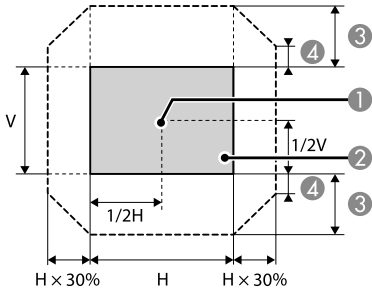

- ① Center of lens
- ② Projected image when the lens position is moved to the home position
- ③ Maximum motion range: $V \times 57\%$
- ④ When the horizontal direction is at the maximum value: $V \times 16\%$

When using the ELPLX01

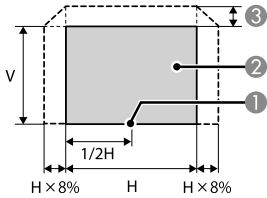

- ① Center of lens
- ② Projected image when the lens position is moved to the home position
- ③ Maximum motion range: $V \times 7\%$

* When the horizontal direction is set to the maximum, the image cannot be moved upward.

Available Keystone Correction Range

H/V-Keystone

If the projector's angle of tilt is within the following range, you can correct distortion in the projected image by using the H/V-Keystone correction function.

Screen Position	ELPLX01	ELPLM08	ELPLU03	ELPLU04 ELPLU02	ELPLR04	ELPLW05	ELPLW06 ELPLW04	ELPLM09 ELPLS04	ELPLM10 ELPLM06	ELPLM11 ELPLM07	ELPLL08 ELPLL07
Vertical Direction	-16° to 16°	-45° to 45°	-28° to 28°	-35° to 35°	-34° to 34°	-40° to 40°	-45° to 45°				
Horizontal Direction	-16° to 16°	-30° to 30°	-28° to 28°	-30° to 30°							

Curved Surface

The values in the table are the minimum values for R/L in the illustration. (Approximate values when projecting at maximum zoom. The ELPLR04 does not support lens shift.)

EB-G7905U/EB-G7900U/EB-G7500U/EB-G7400U/EB-G7200W/EB-G7000W

Horizontally curved surface (concave)

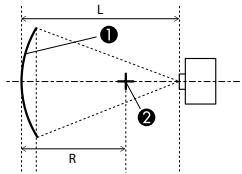

Top view

- ① Screen
- ② Center of the circle of which the curved surface is an arc
- L Projection distance
- R Radius of the circle of which the curved surface is an arc

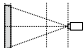
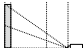
Lens Type	ELPLX01	ELPLU03	ELPLU04 ELPLU02	ELPLR04	ELPLW05	ELPLW06 ELPLW04	ELPLM08	ELPLM09 ELPLS04	ELPLM10 ELPLM06	ELPLM11 ELPLM07	ELPLL08 ELPLL07
Vertical Lens Shift: Home Position  Side view	-	0.45	0.39	0.37	0.35	0.26	0.29	0.21	0.15	0.11	0.08
Vertical Lens Shift: Top  Side view	2.74	0.56	0.40	-	0.37	0.27	0.30	0.22	0.15	0.11	0.08

Horizontally curved surface (convex)

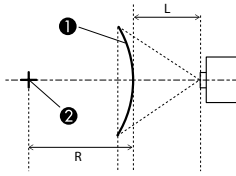

Top view

- 1 Screen
- 2 Center of the circle of which the curved surface is an arc
- L Projection distance
- R Radius of the circle of which the curved surface is an arc

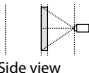
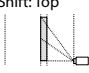
Lens Type	ELPLX01	ELPLU03	ELPLU04 ELPLU02	ELPLR04	ELPLW05	ELPLW06 ELPLW04	ELPLM08	ELPLM09 ELPLS04	ELPLM10 ELPLM06	ELPLM11 ELPLM07	ELPLL08 ELPLL07
Vertical Lens Shift: Home Position 	-	2.13	1.27	1.10	0.95	0.49	0.58	0.33	0.20	0.13	0.09
Vertical Lens Shift: Top 	8.45	2.31	1.37	-	1.01	0.52	0.62	0.35	0.20	0.13	0.09

Vertically curved surface (concave)

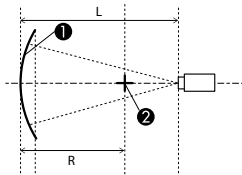

Side view

- 1 Screen
- 2 Center of the circle of which the curved surface is an arc
- L Projection distance
- R Radius of the circle of which the curved surface is an arc

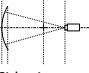
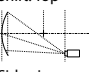
Lens Type	ELPLX01	ELPLU03	ELPLU04 ELPLU02	ELPLR04	ELPLW05	ELPLW06 ELPLW04	ELPLM08	ELPLM09 ELPLS04	ELPLM10 ELPLM06	ELPLM11 ELPLM07	ELPLL08 ELPLL07
Vertical Lens Shift: Home Position 	-	0.37	0.31	0.29	0.27	0.19	0.21	0.15	0.11	0.08	0.06
Vertical Lens Shift: Top 	1.99	0.68	0.44	-	0.35	0.22	0.25	0.17	0.11	0.08	0.06

Vertically curved surface (convex)

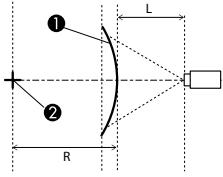

Side view

- ① Screen
- ② Center of the circle of which the curved surface is an arc
- L Projection distance
- R Radius of the circle of which the curved surface is an arc

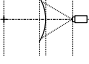
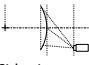
Lens Type	ELPLX01	ELPLU03	ELPLU04 ELPLU02	ELPLR04	ELPLW05	ELPLW06 ELPLW04	ELPLM08	ELPLM09 ELPLS04	ELPLM10 ELPLM06	ELPLM11 ELPLM07	ELPLL08 ELPLL07
Vertical Lens Shift: Home Position 	-	1.07	0.66	0.57	0.49	0.26	0.31	0.18	0.12	0.08	0.06
Vertical Lens Shift: Top 	4.16	1.29	0.79	-	0.59	0.32	0.37	0.22	0.13	0.08	0.06

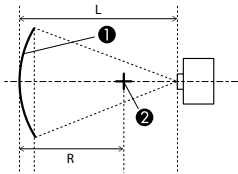

EB-G7805/EB-G7800/EB-G7100

Horizontally curved surface (concave)

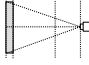

Top view

- ① Screen
- ② Center of the circle of which the curved surface is an arc
- L Projection distance
- R Radius of the circle of which the curved surface is an arc

Lens Type	ELPLX01	ELPLU03	ELPLU04 ELPLU02	ELPLR04	ELPLW05	ELPLW06 ELPLW04	ELPLM08	ELPLM09 ELPLS04	ELPLM10 ELPLM06	ELPLM11 ELPLM07	ELPLL08 ELPLL07
Vertical Lens Shift: Home Position 	-	0.44	0.37	0.35	0.33	0.25	0.27	0.20	0.14	0.11	0.08
Vertical Lens Shift: Top 	1.66	0.60	0.40	-	0.34	0.25	0.27	0.20	0.14	0.11	0.08

Horizontally curved surface (convex)

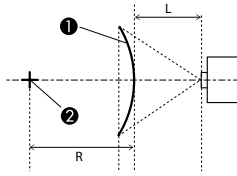

Top view

- ① Screen
- ② Center of the circle of which the curved surface is an arc
- L Projection distance
- R Radius of the circle of which the curved surface is an arc

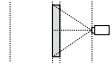
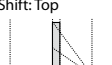

Lens Type	ELPLX01	ELPLU03	ELPLU04 ELPLU02	ELPLR04	ELPLW05	ELPLW06 ELPLW04	ELPLM08	ELPLM09 ELPLS04	ELPLM10 ELPLM06	ELPLM11 ELPLM07	ELPLL08 ELPLL07
Vertical Lens Shift: Home Position 	-	1.81	1.10	0.97	0.83	0.44	0.52	0.31	0.19	0.12	0.09
Vertical Lens Shift: Top 	6.48	1.88	1.14	-	0.86	0.45	0.54	0.31	0.19	0.13	0.09

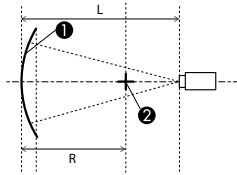
Vertically curved surface (concave)



Side view

- ① Screen
- ② Center of the circle of which the curved surface is an arc
- L Projection distance
- R Radius of the circle of which the curved surface is an arc

Lens Type	ELPLX01	ELPLU03	ELPLU04 ELPLU02	ELPLR04	ELPLW05	ELPLW06 ELPLW04	ELPLM08	ELPLM09 ELPLS04	ELPLM10 ELPLM06	ELPLM11 ELPLM07	ELPLL08 ELPLL07
Vertical Lens Shift: Home Position 	-	0.37	0.32	0.30	0.28	0.20	0.22	0.16	0.11	0.08	0.06
Vertical Lens Shift: Top 	1.73	0.63	0.45	-	0.38	0.25	0.28	0.19	0.13	0.09	0.07

Vertically curved surface (convex)

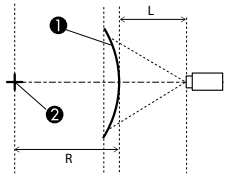

- 1 Screen
- 2 Center of the circle of which the curved surface is an arc
- L Projection distance
- R Radius of the circle of which the curved surface is an arc

Side view

Lens Type	ELPLX01	ELPLU03	ELPLU04 ELPLU02	ELPLR04	ELPLW05	ELPLW06 ELPLW04	ELPLM08	ELPLM09 ELPLS04	ELPLM10 ELPLM06	ELPLM11 ELPLM07	ELPLL08 ELPLL07
Vertical Lens Shift: Home Position 	-	1.08	0.66	0.59	0.50	0.29	0.34	0.21	0.14	0.10	0.07
Vertical Lens Shift: Top 	5.36	1.57	0.94	-	0.71	0.37	0.44	0.26	0.15	0.10	0.07

Corner Wall

The α in the illustration is the maximum angle in which the projector can move. See the table below for detailed values. (Approximate values when projecting at maximum zoom. The ELPLR04 does not support lens shift.)

EB-G7905U/EB-G7900U/EB-G7500U/EB-G7400U/EB-G7200W/EB-G7000W

Concave horizontal corner correction (correction to bilateral symmetry by using corners as the center line)

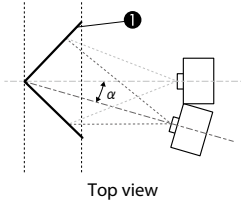

① Screen
 α Movable angle of the projector

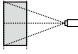
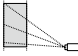
Lens Type	ELPLX01	ELPLU03	ELPLU04 ELPLU02	ELPLR04	ELPLW05	ELPLW06 ELPLW04	ELPLM08	ELPLM09 ELPLS04	ELPLM10 ELPLM06	ELPLM11 ELPLM07	ELPLL08 ELPLL07
Vertical Lens Shift: Home Position  Side view	-	29°	31°	32°	33°	31°	31°	30°	29°	29°	28°
Vertical Lens Shift: Top  Side view	-	9°	14°	-	18°	25°	23°	29°	29°	28°	28°

Convex horizontal corner correction (correction to bilateral symmetry by using corners as the center line)

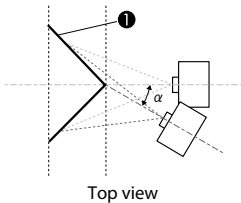

① Screen
 α Movable angle of the projector

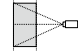
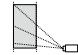

Lens Type	ELPLX01	ELPLU03	ELPLU04 ELPLU02	ELPLR04	ELPLW05	ELPLW06 ELPLW04	ELPLM08	ELPLM09 ELPLS04	ELPLM10 ELPLM06	ELPLM11 ELPLM07	ELPLL08 ELPLL07
Vertical Lens Shift: Home Position  Side view	-	0°	6°	8°	9°	16°	14°	18°	22°	23°	24°
Vertical Lens Shift: Top  Side view	-	*	4°	-	8°	15°	13°	18°	21°	23°	24°

* Cannot correct precisely. Move the lens to the home position.

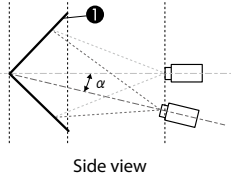
Concave vertical corner correction (correction to horizontal symmetry by using corners as the center line)

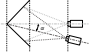

1 Screen
 α Movable angle of the projector

Lens Type	ELPLX01	ELPLU03	ELPLU04 ELPLU02	ELPLR04	ELPLW05	ELPLW06 ELPLW04	ELPLM08	ELPLM09 ELPLS04	ELPLM10 ELPLM06	ELPLM11 ELPLM07	ELPLL08 ELPLL07
Vertical Lens Shift: Home Position  Side view	-	33°	31°	31°	31°	28°	30°	26°	24°	23°	23°
Vertical Lens Shift: Top  Side view	-	*	6°	-	10°	13°	12°	14°	16°	18°	19°

* Cannot correct precisely. Move the lens to the home position.

Convex vertical corner correction (correction to horizontal symmetry by using corners as the center line)

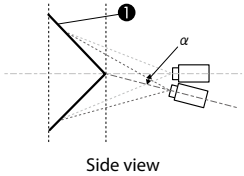

1 Screen
 α Movable angle of the projector

Lens Type	ELPLX01	ELPLU03	ELPLU04 ELPLU02	ELPLR04	ELPLW05	ELPLW06 ELPLW04	ELPLM08	ELPLM09 ELPLS04	ELPLM10 ELPLM06	ELPLM11 ELPLM07	ELPLL08 ELPLL07
Vertical Lens Shift: Home Position  Side view	-	9°	14°	15°	16°	20°	19°	22°	22°	22°	22°
Vertical Lens Shift: Top  Side view	-	*	*	-	*	7°	5°	12°	15°	17°	18°

* Cannot correct precisely. Move the lens to the home position.

EB-G7805/EB-G7800/EB-G7100

Concave horizontal corner correction (correction to bilateral symmetry by using corners as the center line)

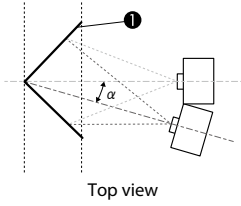

1 Screen
 α Movable angle of the projector

Lens Type	ELPLX01	ELPLU03	ELPLU04 ELPLU02	ELPLR04	ELPLW05	ELPLW06 ELPLW04	ELPLM08	ELPLM09 ELPLS04	ELPLM10 ELPLM06	ELPLM11 ELPLM07	ELPLL08 ELPLL07
Vertical Lens Shift: Home Position 	-	26°	29°	30°	31°	31°	31°	30°	29°	29°	28°
Vertical Lens Shift: Top 	-	7°	13°	-	16°	23°	21°	27°	29°	29°	28°

Convex horizontal corner correction (correction to bilateral symmetry by using corners as the center line)

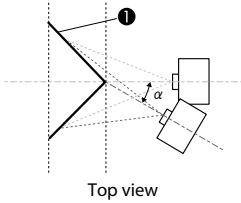

1 Screen
 α Movable angle of the projector

Lens Type	ELPLX01	ELPLU03	ELPLU04 ELPLU02	ELPLR04	ELPLW05	ELPLW06 ELPLW04	ELPLM08	ELPLM09 ELPLS04	ELPLM10 ELPLM06	ELPLM11 ELPLM07	ELPLL08 ELPLL07
Vertical Lens Shift: Home Position 	-	0°	6°	8°	10°	16°	14°	19°	22°	23°	24°
Vertical Lens Shift: Top 	-	*	2°	-	7°	16°	14°	18°	21°	23°	24°

* Cannot correct precisely. Move the lens to the home position.

Concave vertical corner correction (correction to horizontal symmetry by using corners as the center line)

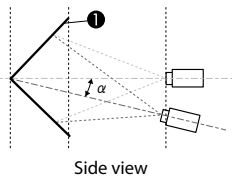

① Screen
 α Movable angle of the projector

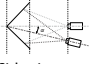
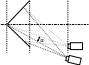

Lens Type	ELPLX01	ELPLU03	ELPLU04 ELPLU02	ELPLR04	ELPLW05	ELPLW06 ELPLW04	ELPLM08	ELPLM09 ELPLS04	ELPLM10 ELPLM06	ELPLM11 ELPLM07	ELPLL08 ELPLL07
Vertical Lens Shift: Home Position  Side view	-	33°	32°	32°	31°	30°	31°	29°	27°	26°	26°
Vertical Lens Shift: Top  Side view	-	*	7°	-	10°	16°	14°	17°	19°	21°	22°

* Cannot correct precisely. Move the lens to the home position.

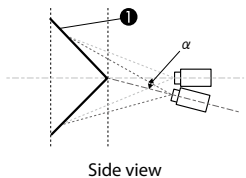
Convex vertical corner correction (correction to horizontal symmetry by using corners as the center line)

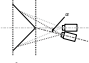

① Screen
 α Movable angle of the projector

Lens Type	ELPLX01	ELPLU03	ELPLU04 ELPLU02	ELPLR04	ELPLW05	ELPLW06 ELPLW04	ELPLM08	ELPLM09 ELPLS04	ELPLM10 ELPLM06	ELPLM11 ELPLM07	ELPLL08 ELPLL07
Vertical Lens Shift: Home Position  Side view	-	6°	12°	13°	14°	19°	18°	21°	23°	24°	25°
Vertical Lens Shift: Top  Side view	-	*	*	-	*	6°	4°	11°	16°	19°	21°

* Cannot correct precisely. Move the lens to the home position.

■ Installation Angle

Vertical: Can be installed at any angle in a complete 360 degrees.

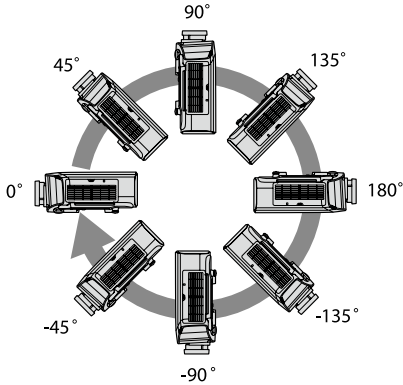

Set [Extended] - [Direction] from the projector's Configuration menu according to the installation angle.

If this is not set, cool down is not performed correctly, and the lamp's life may be reduced significantly.

Horizontal: Can be tilted within the range of expansion and contraction for the rear feet.

When Using Portrait Mode

- If it is used at any angle other than those shown below, a malfunction or an accident could occur.

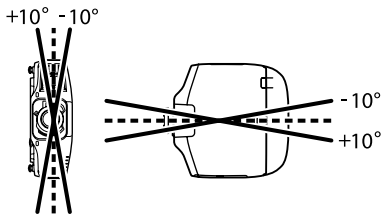

- When performing portrait projection, set [Extended] - [Direction] - [Portrait Mode] to [On] from the projector's Configuration menu.

■ Installation Environment

When installing the projector, make sure there is a gap of at least 50 cm between the wall and the air exhaust vent and the air intake vent.

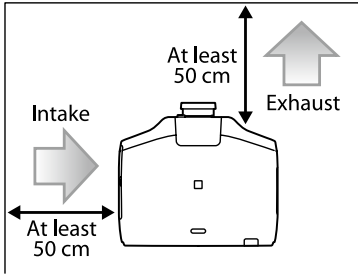

When setting up multiple projectors, make sure there is a gap at least 50 cm between the projectors. Also, make sure that the heat from the air exhaust vent does not go into the air intake vent.

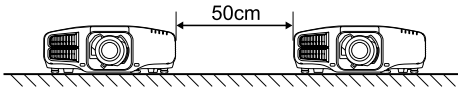

Do not stack projectors directly on top of each other.

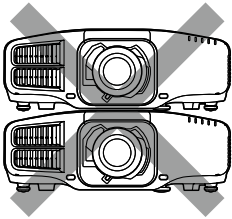

Notes on Portrait Mode

- You need a dedicated ceiling mount for portrait projection. Make sure you contact a specialist to request the ceiling mount.
- Make sure that you install the projector with the air intake vent facing down and that there is a gap at least 10 cm between the projector and the floor and so on. To avoid covering the air intake vent, make sure there is a gap of at least 400 x 200 mm around the base of the projector.

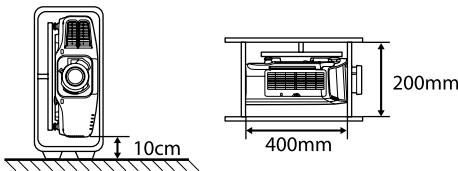

- Do not use a lamp that has been used for more than approximately 2000 hours. This may cause the projector to malfunction or the lamp to deteriorate.

Serial Connection

<At the projector>

<At the computer>

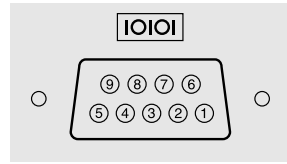
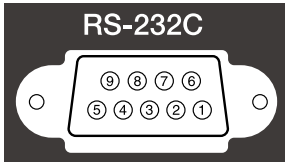

Serial cable (cross)

<At the projector>

<At the computer>

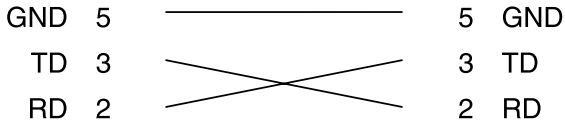

<Serial port specifications>

Connector shape: D-Sub 9-pin (male)

Projector input port name: RS-232C

<Communication specifications>

- Default baud rate setting: 9600 bps
- Data length: 8 bit
- Parity: None
- Stop-bit: 1 bit
- Flow control: None

■ Monitoring and Control

The projector can be monitored and controlled using the following methods. For more details, see the "User's Guide" supplied with the projector.

• ESC/VP21 commands

- When the projector is connected to a computer with an RS-232C cable, you can control the projector with communication commands.
- You can control the projector from a computer connected to the optional HDBaseT transmitter with an RS-232C cable.

• Epson Web Control

By using the Web browser of a computer or a mobile device connected to the projector on a network, you can make projector settings or control the projector.

• PJLink commands

The projector complies with the PJLink Class1 standard established by the JBMIA. From a computer connected to the projector on a network, you can control the projector with PJLink commands.

For more details on PJLink, see the following Web site.

<http://pjlink.jbmia.or.jp/english/>

• EasyMP Monitor (Software provided by Epson)

Allows you to control multiple Epson projectors on a network. You can download EasyMP Monitor from the following Web site.

<http://www.epson.com/>

ESC/VP21 Command List

When the power on command is transmitted to the projector, the power turns on and it enters warm-up mode. When the projector's power has turned on, a colon ":" (3Ah) is returned.

When a command is input, the projector executes the command and returns a ":", and then accepts the next command.

If the command being processed terminates abnormally, an error message is output and a ":" is returned.

Power on/off

Function	Command	Response Value	Content
Power on	PWR ON		
Power off	PWR OFF		
Power status query	PWR?	00	Standby condition
		01	Projecting
		02	Warm-up status
		03	Cooling status
		04	Network monitoring status/communication status
		05	Error standby status
		09	Standby status (external output of images is possible)

Switch input source

Function	Command	Setting Value/ Response Value	Content
Switch input source	SOURCE	10	Computer
Acquire input source	SOURCE?	11	Computer RGB
		14	Computer Component
		1F	Computer Auto
		30	HDMI
		53	LAN
		80	HDBaseT
		A0	DVI-D
		B0	BNC 5BNC
		B1	BNC RGB
		B4	BNC Component
		BF	BNC Auto
		F0	Switch to all input sources in order
		F1	Switch to DVI-D, Computer, BNC, and LAN in order
		F2	Switch to HDMI and HDBaseT in order

A/V Mute function

Function	Command	Settings	Content
A/V Mute function	MUTE	ON	On
		OFF	Off

On-Screen Display settings

Function	Command	Settings	Content
On-Screen Display	ONSCREEN	00	Do not display menus and messages
		01	Display menus and messages

Configuration menu

INC: Increase the setting value/DEC: Decrease the setting value/INIT: Return to defaults

Top Menu	Sub-menu	Epson Web Control Setting Availability	ESCPV21 Public Commands		
			Command	Setting Value/Response Value	
Image	Color Mode	<input type="radio"/>	CMODE xx CMODE?	01: sRGB 04: Presentation 06: Dynamic 0F: DICOM SIM 15: Cinema 1A: Multi-Projection INIT (settings only)	
	Brightness	<input type="radio"/>	BRIGHT xxx BRIGHT?	0-255 INIT/INC/DEC (settings only)	
	Contrast	<input type="radio"/>	CONTRAST xxx CONTRAST?	0-255 INIT/INC/DEC (settings only)	
	Color Saturation	<input type="radio"/>	DENSITY xxx DENSITY?	0-255 INIT/INC/DEC (settings only)	
	Tint	<input type="radio"/>	TINT xxx TINT?	0-255 INIT/INC/DEC (settings only)	
	Sharpness	<input type="radio"/>	SHARP x1 x2 SHARP? x1	x1: Adjustment value 0-255 INC/DEC/INIT x2: Specify specific range 00: Standard (optional) 01: Thin Line Enhancement 02: Thick Line Enhancement	
	White Balance	Color Temp.	<input type="radio"/>	CTEMP xxx CTEMP?	0-255 INIT/INC/DEC (settings only)
		G-M Correction	<input type="radio"/>	FCOLOR xxx FCOLOR?	0-255 INIT/INC/DEC (settings only)
		Customized	<input type="radio"/>	OFFSETR xxx OFFSETR? OFFSETG xxx OFFSETG? OFFSETB xxx OFFSETB? GAINR xxx GAINR? GAING xxx GAING? GAINB xxx GAINB?	0-255 INIT/INC/DEC (settings only)
	Frame Interpolation		<input type="radio"/>	MCFI xx MCFI?	00: Off 01: Low 02: Normal 03: High INIT (settings only)
	Image Enhancement	4K Enhancement*	<input type="radio"/>	4KENHANCE xx 4KENHANCE?	00: Off 01: Full HD 02: WUXGA+
		Image Preset Mode	<input type="radio"/>	IMGPRESET x1 IMGPRESET?	00: Off 01: Preset 1 02: Preset 2 03: Preset 3 04: Preset 4 05: Preset 5
		Noise Reduction	<input type="radio"/>	NRS xx NRS?	0-255 INIT/INC/DEC
		MPEG Noise Reduction	<input type="radio"/>	MPEGNRS x1 MPEGNRS?	00: Off 01: Low 02: Normal 03: High

Top Menu	Sub-menu		Epson Web Control Setting Availability	ESCVP21 Public Commands	
				Command	Setting Value/Response Value
		Super-resolution	<input type="radio"/>	SHRF x1 SHRF? SHRS x1 SHRS?	0-255 INIT/INC/DEC (settings only)
		Detail Enhancement	<input type="radio"/>	DERANGE x1 DERANGE? DESTRENGTH x1 DESTRENGTH?	0-255 INIT/INC/DEC (settings only)
	Advanced	Gamma	<input type="radio"/>	GAMMA xx GAMMA?	20: 2 21: 1 22: 0 23: -1 24: -2 F0: Custom INIT (settings only)
		Gamma (Custom)	<input type="radio"/>	GAMMALV x1 x2 GAMMALV? xx	x1: Gradient 00-08: Gradient 1 to Gradient 9 x2: Adjustment value 0-255 INC/DEC
		RGBCMY	<input type="radio"/>		
		Deinterlacing	<input type="radio"/>		
		Auto Iris	<input type="radio"/>		-
		Reset	<input type="radio"/>		

* EB-G7905U/EB-G7900U/EB-G7500U/EB-G7400U only

Top Menu	Sub-menu	Epson Web Control Setting Availability	ESCPV21 Public Commands	
			Command	Setting Value/Response Value
Signal	Resolution	<input type="radio"/>		-
	Aspect	<input type="radio"/>	ASPECT xx ASPECT?	00: Normal 10: 4:3 20: 16:9 30: Auto 40: Full 50: H-Zoom 60: Native A0: V-Zoom INIT (settings only) <Response value when "Auto" is selected> x1: Mode x2: Auto setting value (fixed at 30)
	Tracking	<input type="radio"/>	TRACKING xxx TRACKING?	0-255 INIT/INC/DEC (settings only)
	Sync.	<input type="radio"/>	SYNC xxx SYNC?	0-255 INIT/INC/DEC (settings only)
	Position	<input type="radio"/>	HPOS xxx HPOS? VPOS xxx VPOS?	0-255 INIT/INC/DEC (settings only)
	Auto Setup	<input type="radio"/>		-
	Overscan	<input type="radio"/>	OVSCAN xx OVSCAN?	00: Off 02: 4% 04: 8% A0: Auto INIT (settings only)
	Blanking	<input type="radio"/>		-
	Advanced	Video Range	<input type="radio"/>	
		Input Signal	<input type="radio"/>	
		Image Processing	<input type="radio"/>	
	Scale	<input type="radio"/>		
	Reset	<input type="radio"/>		

Top Menu	Sub-menu		Epson Web Control Setting Availability	ESCVP21 Public Commands	
				Command	Setting Value/Response Value
Settings	Geometric Correction		<input type="radio"/>	CORRECTMET x1 CORRECTMET?	00: Off 01: H/V-Keystone Correction 02: Quick Corner Correction 03: Point Correction 04: Arc/Curved Surface Correction 05: Corner Wall Correction
		H/V-Keystone	<input type="radio"/>	VKEYSTONE xxx VKEYSTONE? HKEYSTONE xxx HKEYSTONE? VBALANCE x1 VBALANCE? HBALANCE x1 HBALANCE?	0-255 INIT/INC/DEC (settings only)
		Quick Corner	<input type="radio"/>	QC x1 x2 x3 x4 x5 x6 x7 x8 (Set coordinates)	x1 - x8: 0 - 9999 Specify in the order: top left (x, y), top right (x,y), bottom right (x, y), bottom left (x, y)
			<input type="radio"/>	QC? (Acquire coordinate settings)	0-9999 Coordinates (x, y) for 4 points are divided into 4 lines and responded
			<input type="radio"/>	QCV x1 x2 x3 x4 x5 x6 x7 x8 (Vector settings)	x1 - x8: 0 - 99 Specify in the order: top left (x, y), top right (x,y), bottom right (x, y), bottom left (x, y)
	Curved Surface	<input type="radio"/>			
	Corner Wall	<input type="radio"/>			
	Point Correction	<input type="radio"/>			
	Split Screen		<input type="radio"/>	SPS x1 x2 SPS?	x1 01: Execute/Release Split Screen x2 00: Release Split Screen 01: Execute Split Screen x1 02: Set Screen Size x2 00: Equal 01: Larger Left 02: Larger Right x1 03: Source (Screen Left) 04: Source (Screen Right) x2 See "Switch source". x1 05: Swap Screens x1 06: Audio Source x2 00: Auto 01: Screen Left 02: Screen Right x1 00: Acquire All Current Settings (information only) x1 INIT
		Volume	<input type="radio"/>	VOL xxx VOL?	0-255 INIT/INC/DEC (settings only)

Top Menu	Sub-menu		Epson Web Control Setting Availability	ESCVP21 Public Commands	
				Command	Setting Value/Response Value
	Lock Setting	Control Panel Lock	<input type="radio"/>		-
		Lens Lock	<input type="radio"/>		
	Power Consumption*		<input type="radio"/>	LUMINANCE xx LUMINANCE?	00: Off 01: On INIT (settings only)
	Remote Receiver		<input type="radio"/>	-	
	User Button		<input checked="" type="checkbox"/>		
	Test Pattern		<input type="radio"/>		
	Memory	Memory	<input type="radio"/>	POPMEM x1 x2 (Load) PUSHMEM x1 x2 (Register) ERASEMEM x1 x2 (Delete) - (Rename)	x1 Memory Type 02: Advanced x2 Memory No. 01: Memory 1 (1st) 02: Memory 2 (2nd) 03: Memory 3 (3rd) 04: Memory 4 (4th) 05: Memory 5 (5th) 06: Memory 6 (6th) 07: Memory 7 (7th) 08: Memory 8 (8th) 09: Memory 9 (9th) 0A: Memory 10 (10th)
			<input type="radio"/>	POPLP xx (Load) PUSHLP xx (Register) ERASELP xx (Delete)	00: All 01: Memory 1 (1st) 02: Memory 2 (2nd) 03: Memory 3 (3rd) 04: Memory 4 (4th) 05: Memory 5 (5th) 06: Memory 6 (6th) 07: Memory 7 (7th) 08: Memory 8 (8th) 09: Memory 9 (9th) 0A: Memory 10 (10th)
			<input type="radio"/>	POPGC x1 (Load) PUSHGC x1 (Register) ERASEGC x1 (Delete) NAMEGC x1 x2 (Rename) NAMEGC? x1 (Acquire Name)	x1 Memory Type 00: ALL 01: Memory 1 (1st) 02: Memory 2 (2nd) 03: Memory 3 (3rd) x2 Custom name (ASCII code)
	Reset		<input type="radio"/>	-	

* EB-G7905U/EB-G7900U/EB-G7500U/EB-G7200W/EB-G7000W/EB-G7805/EB-G7800/EB-G7100 only

Top Menu	Sub-menu		Epson Web Control Setting Availability	ESCVP21 Public Commands	
				Command	Setting Value/Response Value
Extended	Home Screen	Home Screen Auto Disp.	<input type="radio"/>	AUTOHOME x1 AUTOHOME?	00: Off 01: On
		Custom function	<input type="radio"/>	HFUNC x1 x2 HFUNC? x1	x1 Custom target 01: Custom Function 1 02: Custom Function 2 x2 Assigned functions 01: Power Consumption*1 03: Network Settings 08: Info 0C: Frame Interpolation 0D: Split Screen

Top Menu	Sub-menu		Epson Web Control Setting Availability	ESCV21 Public Commands				
				Command	Setting Value/Response Value			
Display	Menu Position	○	MENUDISP mode param MENUDISP? mode	mode: Specify Setting Mode 01: Menu Position param: Menu Position 00: Center 01: Center Left 02: Top Left 03: Top Center 04: Top Right 05: Center Right 06: Bottom Right 07: Bottom Center 08: Bottom Left INIT (settings only)				
			Message Position	✕	MSGPOS x1 MSGPOS?	00: Center 01: Center Left 02: Top Left 03: Top Center 04: Top Right 05: Center Right 06: Bottom Right 07: Bottom Center 08: Bottom Left		
					Messages	○	-	
					Display Background	○		
					Startup Screen	○		
					Standby Confirmation	○	STANDBYCONF mode STANDBYCONF?	00: Standby Confirmation Off 01: Standby Confirmation On INIT (settings only)
					Air Filter Notice	○	FLCLENOT x1 FLCLENOT?	00: Off 01: On INIT (settings only)
					Screen	○	SCFORMAT mode param SCFORMAT? mode	01: Screen Type Settings 01: 4:3 02: 16:9 03: 16:10 02: Screen Position Settings C19 (-999) to 000 to 3E7 (999) INIT (settings only)
					Panel Alignment	○	-	
					Color Uniformity	○		
					OSD Rotation	○		OSDROTATE x1 OSDROTATE?
					User's Logo	✕	-	
					Projection	○	VREVERSE xxx VREVERSE? HREVERSE xxx HREVERSE?	ON: Reversed OFF: Normal INIT (settings only)

Top Menu	Sub-menu	Epson Web Control Setting Availability	ESCV21 Public Commands		
			Command	Setting Value/Response Value	
	Direction	Direction	<input type="radio"/>	ANGLE param ANGLE?	param Angle specifications 00-23: 0 Degrees - 345 Degrees NIT/INC/DEC (settings only)
		Portrait Mode	<input type="radio"/>	HANGLE param HANGLE?	param 00: Off 06: On INIT (settings only)
	Operation	Direct Power On	<input type="radio"/>	-	
		Sleep Mode	<input type="radio"/>		
		Sleep Mode Timer	<input type="radio"/>		
		High Altitude Mode	<input type="radio"/>		
		Auto Source Search	<input type="radio"/>	AUTOSEARCH x1 AUTOSEARCH?	00: Off 01: On
		Auto Power On	<input type="radio"/>	-	
		A/V Mute Settings	<input type="radio"/>	FADEIN x1 FADEIN? FADEOUT x1 FADEOUT? - (A/V Mute Timer) - (A/V Mute Release)	0-9: 0.0s 10-19: 0.5s 20-29: 1.0s 30-39: 1.5s 40-49: 2.0s 50-59: 2.5s 60-69: 3.0s 70-79: 3.5s 80-89: 4.0s 90-99: 4.5s 100-109: 5.0s 110-119: 5.5s 120-129: 6.0s 130-139: 6.5s 140-149: 7.0s 150-159: 7.5s 160-169: 8.0s 170-179: 8.5s 180-189: 9.0s 190-199: 9.5s 200-209: 10.0s 210-255: No operations
		BNC Sync Termination	<input checked="" type="checkbox"/>	-	
		Remote Control Type	<input type="radio"/>	RCTYPE xx RCTYPE?	00: Normal 01: Simple INIT (settings only)
		Beep	<input type="radio"/>	-	
	Indicators	<input type="radio"/>	ILLUM xx ILLUM?	00: Off 01: On	
	Instant Off	<input type="radio"/>	INSTANTOFF x1 INSTANTOFF?	00: Instant Off Disabled 01: Instant Off Enabled	
	Inv Direction Button	<input type="radio"/>	KREVERSE xx KREVERSE?	10: Off 11: On INIT (settings only)	
	HDMI DDC Buffer	<input checked="" type="checkbox"/>	-		
	DVI-D DDC Buffer	<input checked="" type="checkbox"/>	-		

Top Menu	Sub-menu		Epson Web Control Setting Availability	ESCVP21 Public Commands	
				Command	Setting Value/Response Value
		Lens Type	×	SFLENS mode SFLENS?	00: ELPLS04 01: ELPLU02 02: ELPLR04 03: ELPLW04 04: ELPLM06 05: ELPLM07 06: ELPLL07 INIT Information only: 10: ELPLM08 11: ELPLX01 12: ELPLU03 13: ELPLU04 14: ELPLW05 15: ELPLW06 16: ELPLM09 17: ELPLM10 18: ELPLM11 19: ELPLL08
		Date & Time	○		-
		Lens Calibration	×	LENSCALB	
	A/V Settings	A/V Output	○	AVOUT x1 AVOUT?	00: While Projecting 01: Always On INIT (settings only)
		Monitor Out	○		-
		Audio Settings	○	AUDIO mode [source]	Audio Settings (without source) mode: change setting 00: Auto 01: Audio1 02: Audio2 03: Audio3 INIT (settings only) HDMI Audio Output Settings mode: change setting 00: Default (HDMI) 03: Audio3 INIT (settings only) source: target source 30: HDMI
		Standby Mode	○		-
	HDBaseT	Control Communications	○	HDBASET mode HDBASET?	00: Off 01: On INIT (settings only)
		Extron XTP	○	XTP XTP?	00: Off 01: On

Top Menu	Sub-menu		Epson Web Control Setting Availability	ESCVP21 Public Commands		
				Command	Setting Value/Response Value	
	Multi-Projection	Projector ID	<input type="radio"/>	PROJID xx PROJID?	00: Off 01 to 30: ID1 to ID30 INIT (settings only)	
		Tiling	<input type="radio"/>		-	
		Geometric Correction	<input type="radio"/>	See [Geometric Correction] from [Settings].		
		Edge Blending	<input type="radio"/>		-	
		Scale	<input type="radio"/>		-	
		Color Mode	<input type="radio"/>	See [Color Mode] from [Image].		
		Brightness Level*1	<input type="radio"/>	LUMLEVEL level LUMLEVEL?	01: Level 1 02: Level 2 03: Level 3 04: Level 4*2 05: Level 5*2 INIT (settings only)	
		Color Matching	<input type="radio"/>	MULSCR x1 x2 x3	x1: Adjustment Type 01: Pattern Guide 05: Color Correct R 06: Color Correct G 07: Color Correct B 08: Color Correct (RGB Batch) x2: Level Settings 00: Off (x1 = 01 only) 01: Level 1 02: Level 2 03: Level 3 04: Level 4 05: Level 5 06: Level 6 07: Level 7 08: Level 8 x3: Adjustment value (except x1 = 01) 0-255 INIT/INC/DEC	
			<input type="radio"/>	MULSCR? xx	x1: Adjustment Type 01: Pattern Guide 05: Color Correct R 06: Color Correct G 07: Color Correct B Responds to the settings or level value for each level of the specified adjustment type. Level value: 00 to 08 Adjustment Number: 000 to 255	
			<input type="radio"/>		-	
		Color Uniformity	<input type="radio"/>		-	
		RGBCMY	<input type="radio"/>		-	
		Black Level	<input type="radio"/>		-	
		Schedule Settings	<input type="radio"/>		-	
Language	<input checked="" type="radio"/>		-			
Reset	<input type="radio"/>		-			

*1 EB-G7905U/EB-G7900U/EB-G7500U/EB-G7200W/EB-G7000W/EB-G7805/EB-G7800/EB-G7100 only.

*2 EB-G7905U/EB-G7900U/EB-G7500U/EB-G7200W/EB-G7805/EB-G7800 only.

Top Menu	Sub-menu		Epson Web Control Setting Availability	ESCPV21 Public Commands	
				Command	Setting Value/Response Value
Info	Projector Info	Source	<input type="radio"/>	SOURCE?	See "Switch source" for the response values.
		Input Signal	<input type="radio"/>		-
		Resolution	<input type="radio"/>	RESOL?	00: Auto 01 to 02, 08 to 2D: Manual A0: Customized 1 A1: Customized 2 F0: Wide F1: Normal INIT (settings only)
		Refresh Rate	<input type="radio"/>		-
		Sync Info	<input type="radio"/>		
		Status	<input type="radio"/>		
		Serial Number	<input type="radio"/>		
		Lens Type	<input type="radio"/>	See [Lens Type] from [Extended] - [Operation].	
		Event ID	<input type="radio"/>		-
	HDBaseT Signal Level	<input checked="" type="radio"/>			
	Lamp Info	Lamp Hours	<input type="radio"/>	LAMP?	LAMP = x1 x1: Lamp Hours
	Version		<input type="radio"/>		-
	Status Info		<input type="radio"/>		-

Top Menu	Sub-menu		Epson Web Control Setting Availability	ESCPV21 Public Commands	
				Command	Setting Value/Response Value
Reset	Reset Lamp Hours		<input checked="" type="radio"/>		-
	Reset All Memories		<input type="radio"/>		
	Reset All		<input type="radio"/>	INITALL	-

Network menu

Top Menu	Sub-menu	Web Control Setting Availability	ESCP21 Public Commands	
			Command	Setting Value/Response Value
Basic	Projector Name	<input type="radio"/>		
	PJLink Password	<input type="radio"/>		
	Remote Password	<input type="radio"/>		
	Web Control Password	<input type="radio"/>		
	Projector Keyword	<input type="radio"/>		
	Display LAN Info.	<input type="radio"/>		
Wireless LAN	Connection Mode	<input type="radio"/>		
	Search Access Point	<input checked="" type="radio"/>		
	SSID	<input type="radio"/>		
	Security	<input type="radio"/>		
	Passphrase	<input type="radio"/>		
	Channel	<input type="radio"/>		
	DHCP	<input type="radio"/>		
	IP Address	<input type="radio"/>		
	Subnet Mask	<input type="radio"/>		
	Gateway Address	<input type="radio"/>		
	SSID Display	<input type="radio"/>		
IP Address Display	<input type="radio"/>			
Wired LAN	DHCP	<input type="radio"/>		
	IP Address	<input type="radio"/>		
	Subnet Mask	<input type="radio"/>		
	Gateway Address	<input type="radio"/>		
	IP Address Display	<input type="radio"/>		
Notifications	Mail Notification	<input type="radio"/>		
	SMTP Server	<input type="radio"/>		
	Port Number	<input type="radio"/>		
	From	<input type="radio"/>		
	Address Setting	<input type="radio"/>		
	SNMP	<input type="radio"/>		
	Trap IP Address	<input type="radio"/>		
	Community Name	<input type="radio"/>		
Others	Priority Gateway	<input type="radio"/>		
	AMX Device Discovery	<input type="radio"/>		
	Crestron RoomView	<input checked="" type="radio"/>		
	Control4 SDDP	<input type="radio"/>		
	Message Broadcasting	<input type="radio"/>		

PJLink Command List

See the following for more information on controlling the projector from a computer using PJLink protocols.

Function	Command	Setting Value / Response Value		Content	Notes
Power control instruction	POWR	0		Power-off (Standby)	
		1		Power-on (Lamp-on)	
Power status query	POWR?	0		Power-off (Standby)	
		1		Power-on (Lamp-on)	
		2		Cooling status	
		3		Warm-up status	
Input switch instruction Input switch query	INPT INPT?	11		Computer	
		13		BNC	
		31		DVI-D	
		32		HDMI	
		52		LAN	
		56		HDBaseT	
Input toggling list query	INST?	11		Computer	Displays a list of the available input sources of the projector.
		13		BNC	
		31		DVI-D	
		32		HDMI	
		52		LAN	
		56		HDBaseT	
Error status query	ERST?	First character	2	Fan error	"0" is displayed when no error has occurred.
			Second character	1	
		2		Lamp error	
			Lamp failure		
		Third character		1	
			2	Temperature error	
		Fourth character	0	Cover open (Does not apply to model being used.)	
		Fifth character	1	No Air Filter Warning Filter Warning	
			2	Filter error	
		Sixth character	1	Other warnings	
			2	Other errors	
		Mute instruction	AVMT	30	
Mute status query	AVMT?	31		A/V mute on	
Lamp number/ lighting hour query	LAMP?	First number (1 to 5)	0 to 99999	Cumulative lighting time of lamp	
			Second number	0	Lamp off
		1		Lamp on	
Projector name query	NAME?	*	*	* Displays the name set in [Network] - [Basic] - [Projector Name] from the projector's Configuration menu.	
Manufacture name information query	INF1?	EPSON		Manufacture name	
Model name information query	INF2?	EPSON G7905U/G7900U		EB-G7905U or EB-G7900U	
		EPSON G7500U		EB-G7500U	
		EPSON G7400U		EB-G7400U	
		EPSON G7200W		EB-G7200W	
		EPSON G7000W		EB-G7000W	
		EPSON G7805/G7800		EB-G7805 or EB-G7800	
		EPSON G7100		EB-G7100	
Class information query	CLSS?	1		Class information	

-The password for PJLink is set in [Network] - [Basic] - [PJLink Password] from the projector's Configuration menu. If you do not want to use a password, leave PJLink Password blank.

-PJLink is a trademark applied for registration or is already registered in Japan, the United States of America and other countries and areas.

■ Cautions

1. The copyright for this guide is owned by the SEIKO EPSON CORPORATION. No part of this document may be reproduced, stored in a retrieval system, or transmitted in any form or by any means, electronic, mechanical, photocopying, recording, or otherwise, without the prior written permission of SEIKO EPSON CORPORATION.
2. This guide is only to be used as an instruction guide for projector products from the SEIKO EPSON CORPORATION.

■ Disclaimer

1. The contents of this document are subject to change without notice.
2. While every precaution has been taken in the preparation of this document, SEIKO EPSON CORPORATION assumes no responsibility for errors or omissions. Neither is any liability assumed for damages resulting from the use of the information contained herein.
3. Responsibility for use of this guide lies with the user. SEIKO EPSON CORPORATION shall not be liable to the purchaser of this product or third parties for damages, losses, costs, or expenses incurred by the purchaser or third parties as a result of use of this guide.

EPSON®
EXCEED YOUR VISION